

MAXSEAL™

INSTALLATION MANUAL

PerformMax Industrial Doors
5 Crozerville Road, Aston, PA 19014
+1 (484) 840-8500

WWW.PERFORMAXGLOBAL.COM
INFO@PERFORMAXGLOBAL.COM

Manufacturer

PerforMax Global
5 Crozerville Road
Aston, PA 19014
Office: +1 (484) 840-8500

Door Details

Date:
Installing Dealer:
Project:
Door Model:
Serial Number:
Clear Opening Between Guides:
Clear Opening Height:

General

This Installation and Maintenance Manual is to help you install MaxSeal Vinyl Door and ensure the door provides reliable and economical operation. DO NOT begin to install a MaxSeal Vinyl Door unless you have read all the instructions in this manual. Please contact PerforMax Global Technical Support at +1 (484) 840-8500 at any time during the install.

Symbols Used in this Document



NOTICE

Highlights important information.



CAUTION

Failure to follow instructions or avoid the described situation may result in damage to equipment.



WARNING / DANGER

Failure to follow instructions or avoid the described situation may result in damage to equipment, serious injury and/or death to person(s).

Safety and Power Isolation



An understanding of the system's functions and operation by trained and competent technicians is essential for safe installation, maintenance, troubleshooting and repair.



Incoming energy to the electric motor (door operator) should be isolated using accepted Lock-Out/Tag-Out procedures for electric isolation. Also isolate any equipment near the installation site if the equipment may be inadvertently operated into the door installation area.



Use proper lifting equipment and techniques. Properly secure all loads.

SAFETY INFORMATION

TO PREVENT INJURY TO YOURSELF OR ANYONE AROUND YOU, PLEASE READ SAFETY INFORMATION AND OCCASIONAL REVIEW THEM AS YOU ARE INSTALLING A PERFORMAX GLOBAL HIGH PERFORMANCE DOOR.

- Inspect all components and call Performax Global if problems arise.
 - Be sure to anchor guides into secure walls. Only attaching to drywall or sheet rock with result in failure and/or injury.
 - If repairs are required to your high performance overhead door, please call your service provider and/or Performax Global.
 - Be sure to ask for assistance if lifting anything heavy.
 - Follow instructions carefully and check out Performax Global's YouTube videos for instructional videos.
 - If door is equipped with a torsion tube, use caution when adjusting the tension wheel.
 - Only use hardware that is supplied by Performax Global.
-
- Test safety devices before approving proper operation.
 - If grinding or cutting, but sure to wear proper personal safety equipment.
 - Head plates are carrying a lot of weight. Do not attempt to loosen without supporting the curtain first.
 - Be sure safety devices are fully operational before the door goes into operating mode.
 - Do not let children play with the controls.
 - Be sure the guides are adjusted correctly or the door will not operate correctly.
 - Only licensed operators to move heavy machinery.

STEP 1

- Remove bolts shown in View A and View B
- Remove any additional hardware fastening guides together and repeat for left side guides

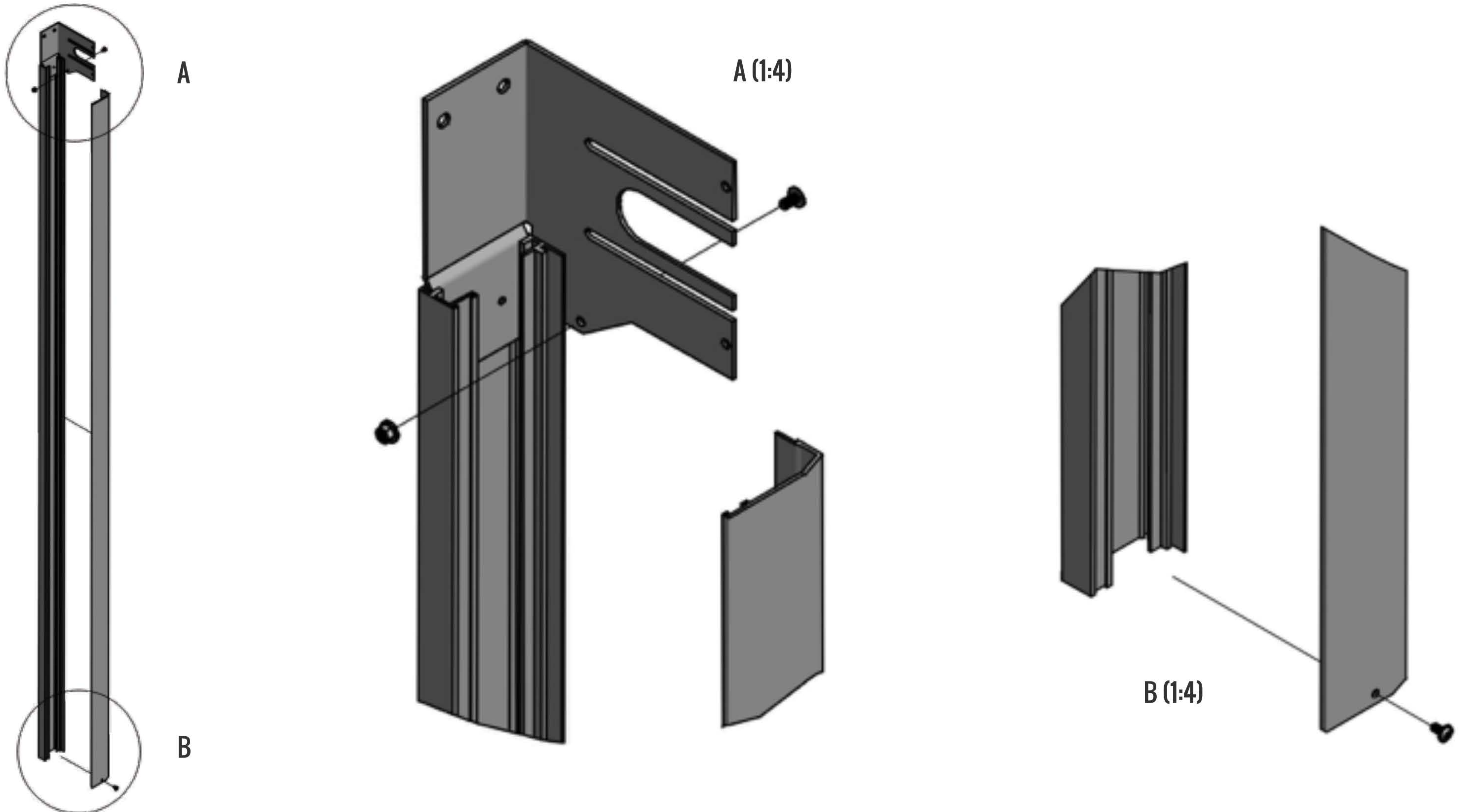

STEP 2

- Lay guides on the floor with lintel bar between top of each guide
- Align holes on lintel bar with holes at the top of each guide C (1:3)
- Make sure 'flat side' of lintel bar is aligned with 'flat side' of the back of the guide as shown

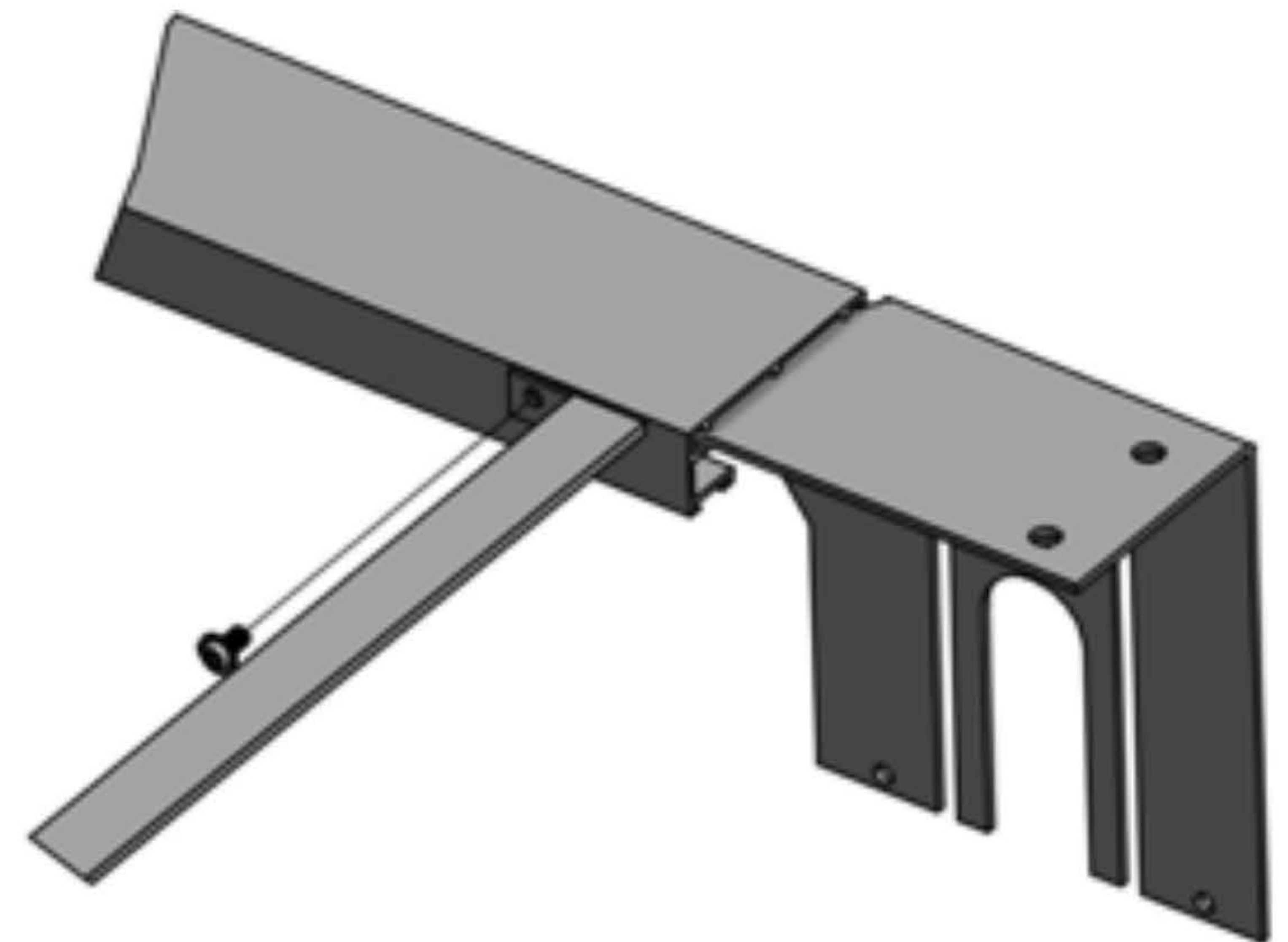

C (1:3)

STEP 3

- Lift door upright and move towards wall
- Line inside of guides up with clearance width
- Make sure all components stay square to one another
- Affix door to wall using appropriate fasteners for material of wall

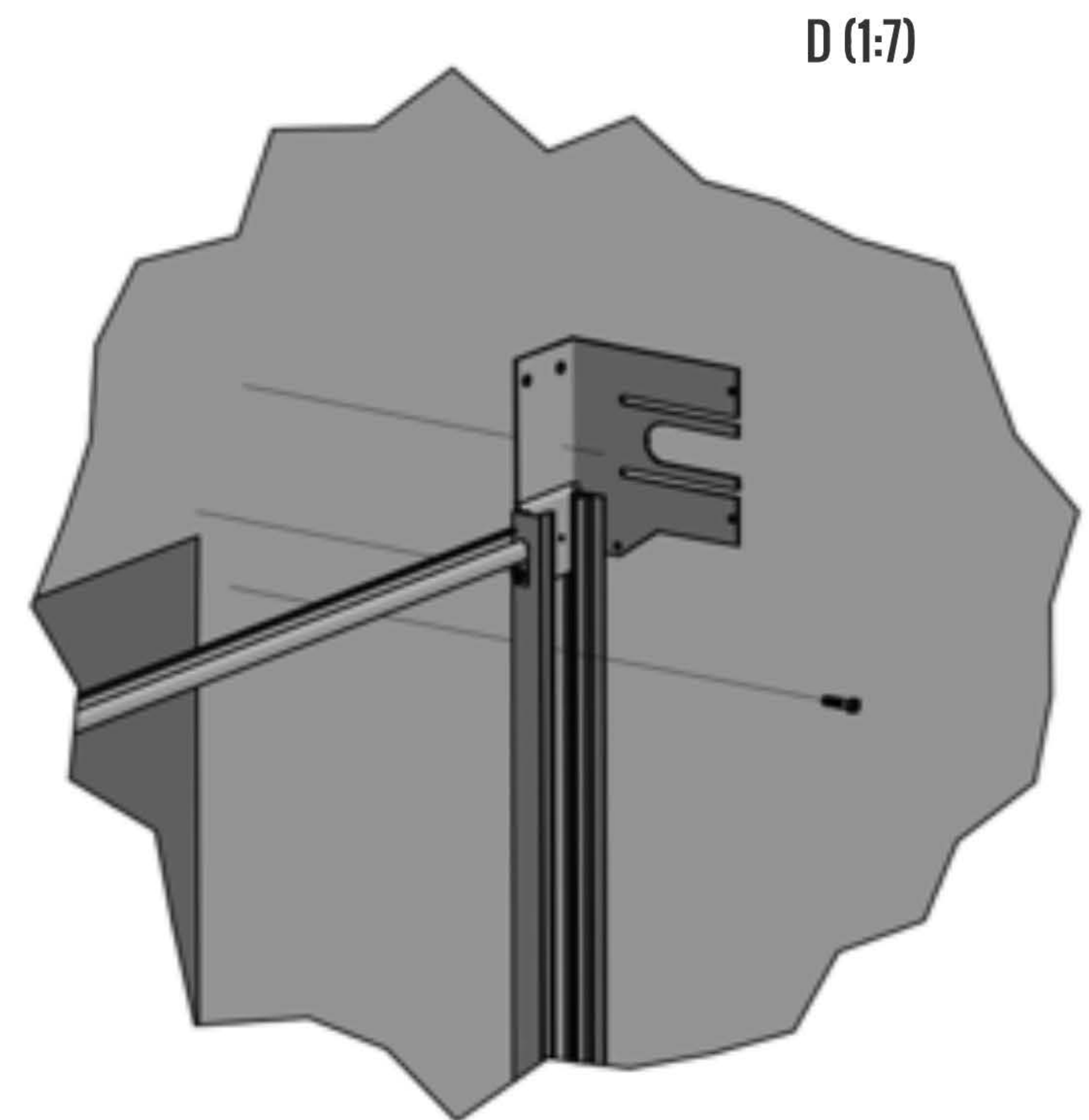
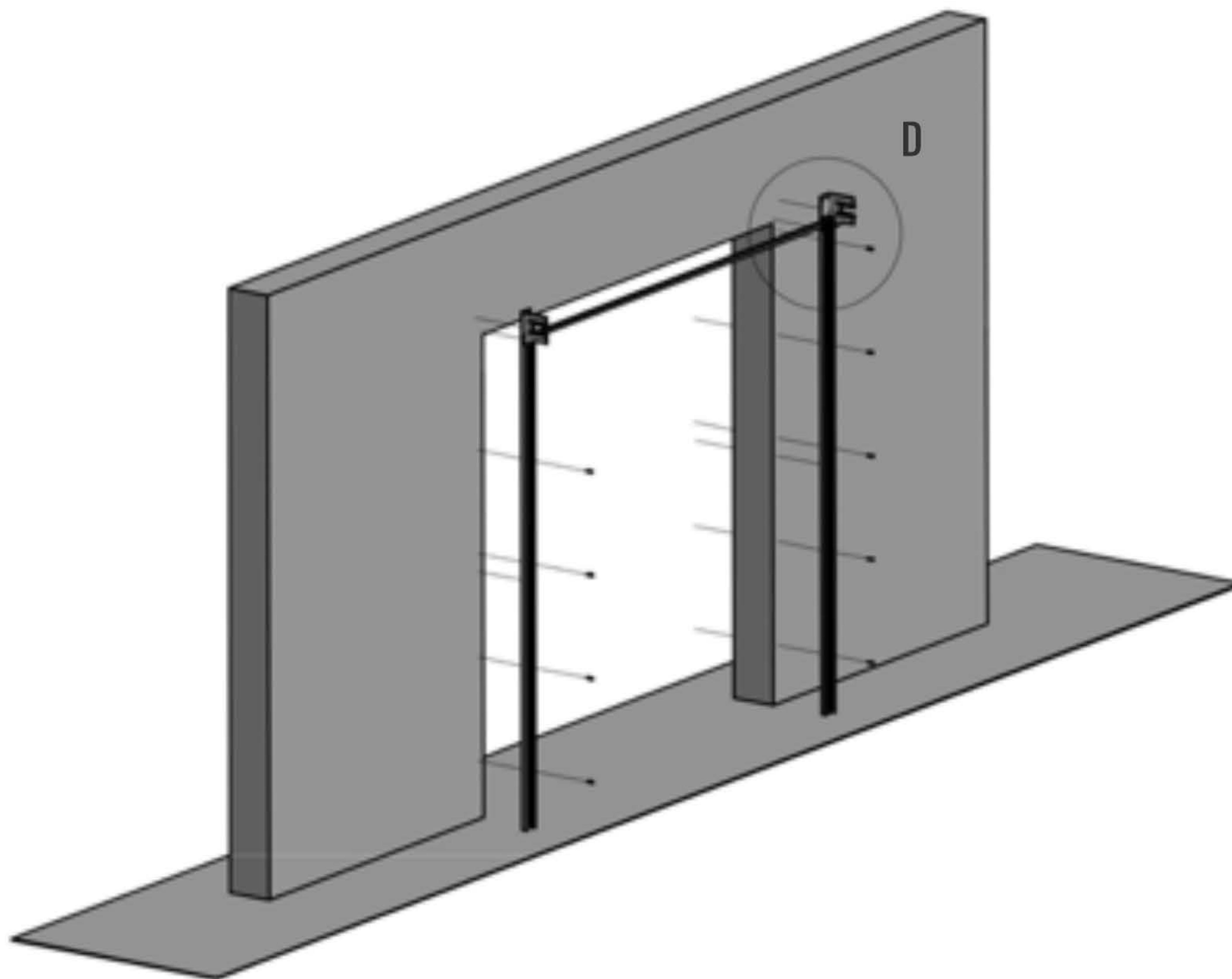

STEP 4

- Slide included bearing onto non-drive side of curtain roll
- Lift curtain assembly in the air and slide the curtain roll shaft into the largest diameter slot on head plate

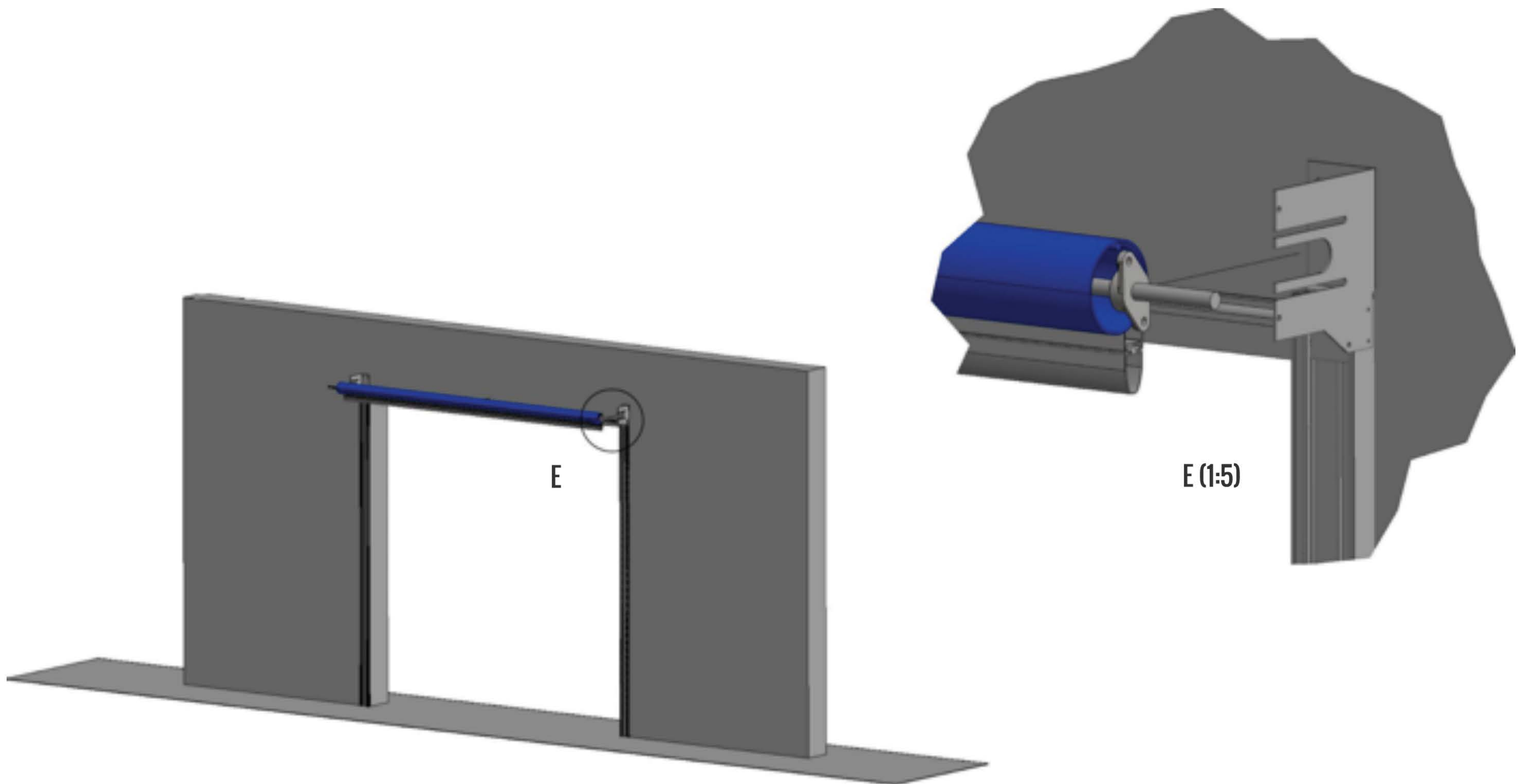

STEP 5

- Center curtain between guides by measuring distance from inside of head plate to edge of curtain as shown
- Distance 'X' should be equal on both sides

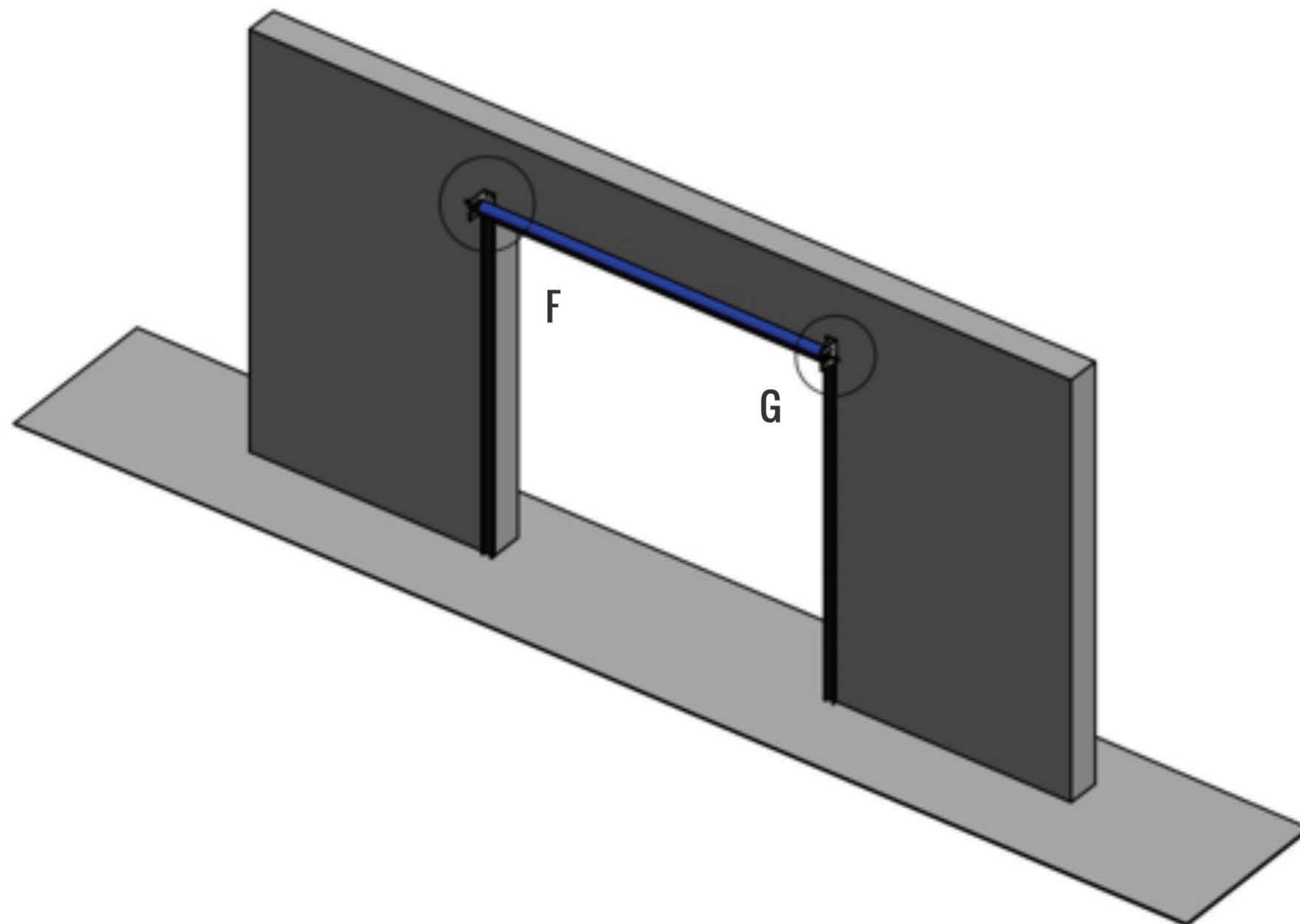

F (1:8)

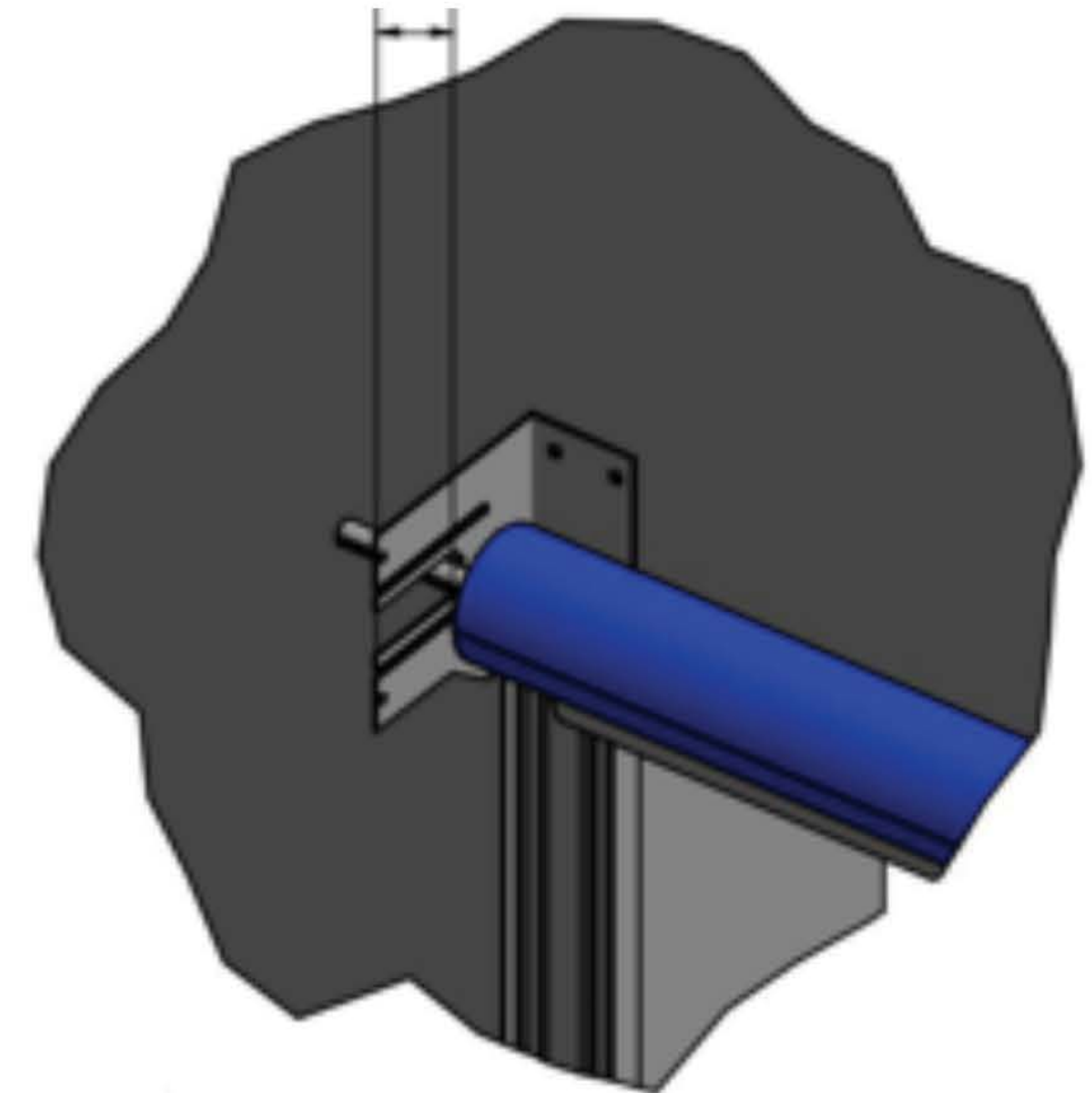

G (1:8)

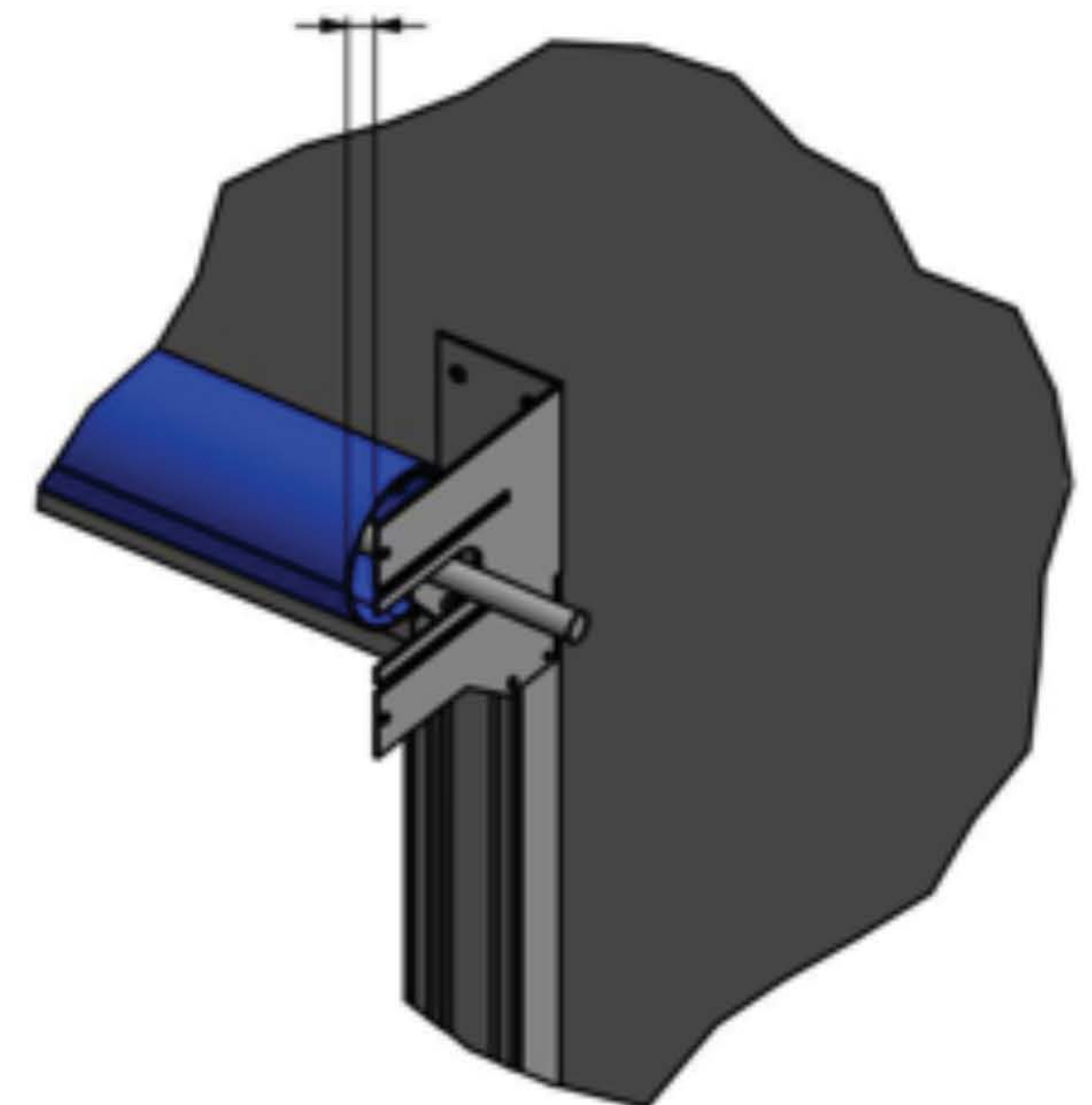

STEP 6

- Bolt bearing to head plate using the included hardware in the order shown below:

Parts List

ITEM	QTY	DESCRIPTION
1	1	MaxSeal Head Plate
2	1	MaxSeal Bearing
3	2	Bearing Cap Screw
4	2	Washer
5	2	Split Lock Washer
6	2	Nut
7	1	Locking Collar

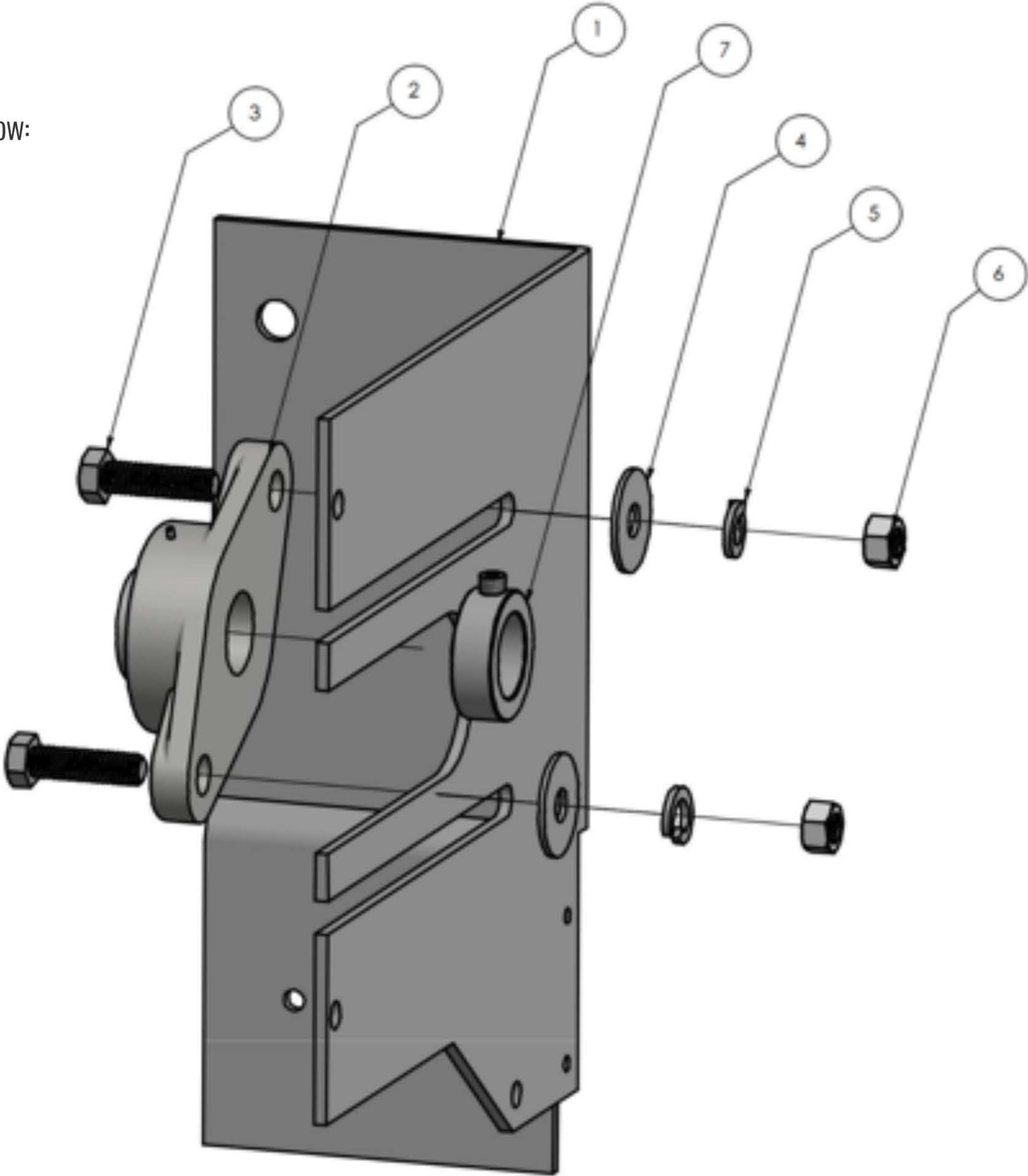

STEP 7

- Place shaft key in shaft keyway between pins as shown in View H
- Slide motor onto shaft
- Bolt motor to head plate using included hardware in the order shown
- Ensure that both bearing and motor hardware are tightened sufficiently

Parts List

ITEM	QTY	DESCRIPTION
1	1	MaxSeal Head Plate
2	1	Operator Motor
3	4	Aluminum Stand Off
4	4	Washer
5	4	Split Lock Washer
6	4	Motor Cap Screw

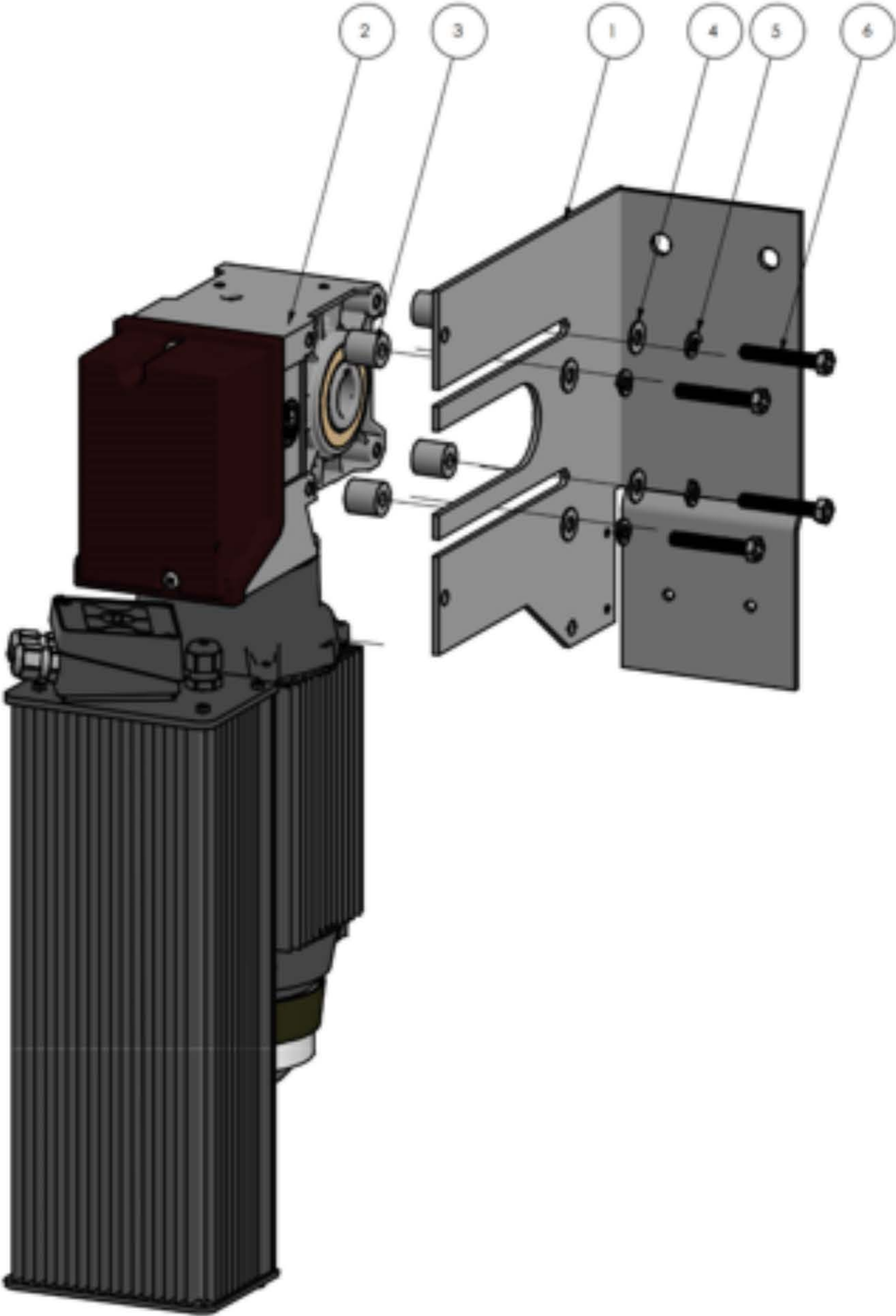
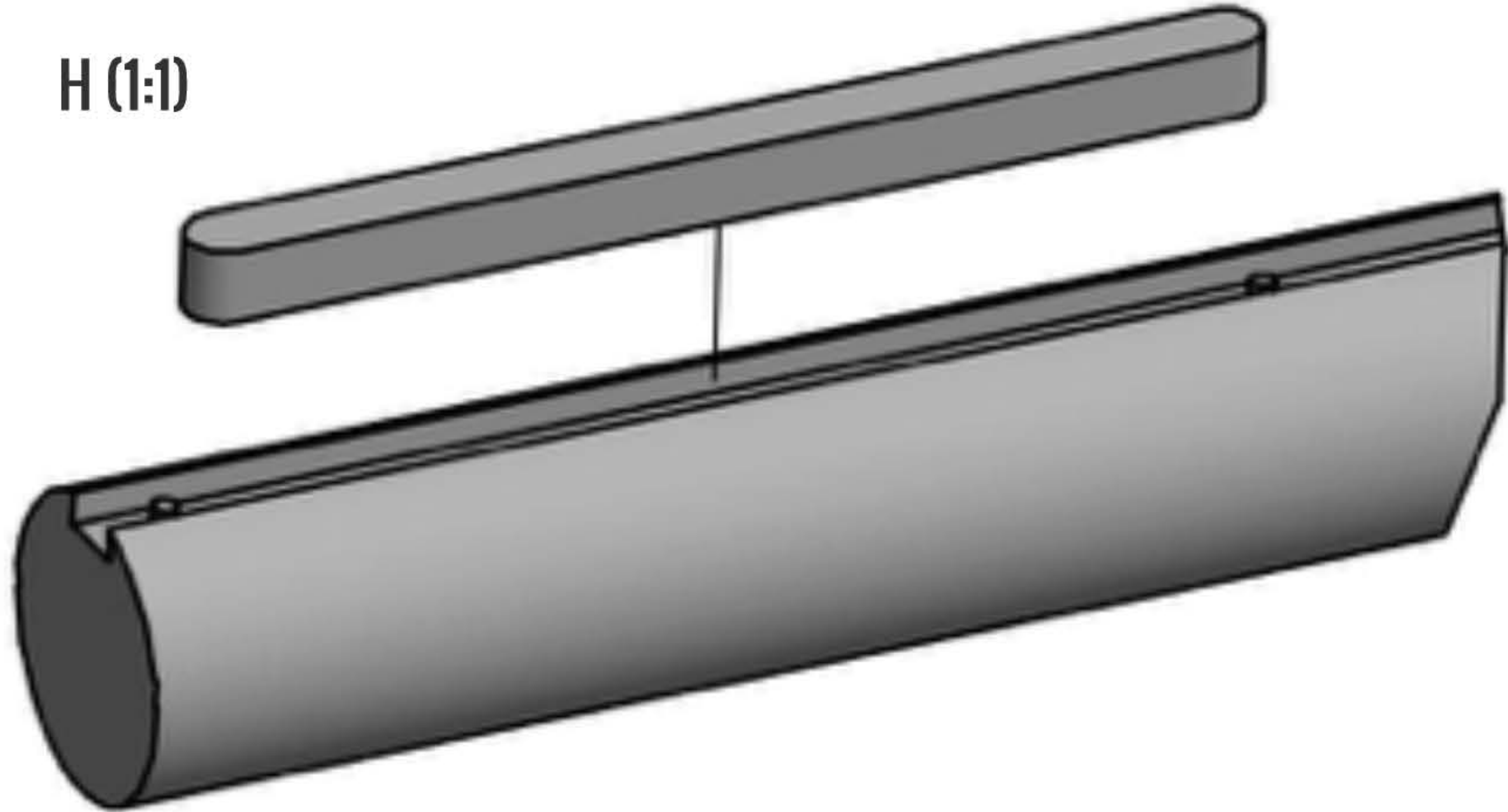

STEP 8

- Replace front guides onto assembled door
- Install using hardware removed in Step 1

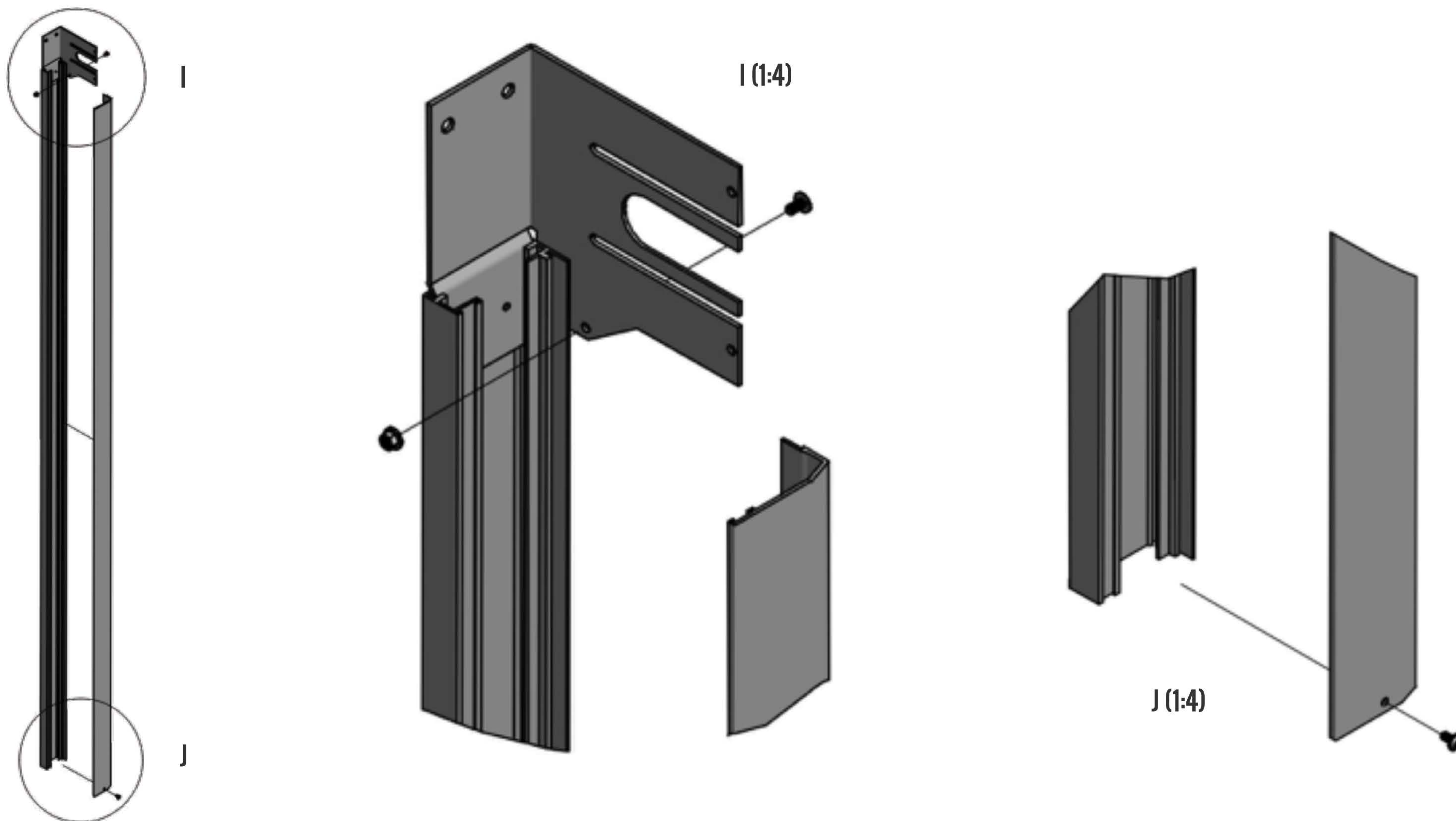

MAXSEAL PARTS LIST

Item	Part #	MaxSeal Item	Quanti		Part #	Options
1	M-001	Left Rear Guide	1		M-040	Wireless Safety Edge
2	M-002	Left Front Guide	1		M-041	Safety Edge Coil Cord
3	M-003	Right Rear Guide	1		M-042	Thru Beam Photo Eye
4	M-004	Right Front Guide	1		M-043	Photo Eye Wire
5	M-005	Plastic Guide Rails	4		M-044	Photo Eye Bracket
8	M-008	Internal Bottom bar Weight	1		M-045	Photo Eye Reflective Disk
9	M-009	Aluminum Bottom Bar	1		M-046	Curtain Cover
11	M-011	Curtain Rollers	Varies		M-047	Motor Cover
12	M-012	Curtain Roller screws	Varies		M-048	Guide Brush Seal
13	M-013	Vinyl connecting roller to curtain	Varies		M-049	Guide Brush Seal Bracket
14	M-014	Reflective Photo Eye	1		M-050	Guide Brush Seal Rivets
15	M-015	Photo Eye Wire	1		M-051	3-Button Station
16	M-016	Photo Eye Bracket	1		M-052	Mushroom Button
17	M-017	Photo Eye Reflective Disk	1		M-053	Loop Detector
18	M-018	Safety Edge	1		M-054	Falcon Eye
19	M-019	Vinyl Loop for Safety Edge	1			
23	M-023	Head plate	2			
24	M-024	Bearings 1"	2			
25	M-025	Bearing Bolts	8			
26	M-026	Bearing Washer	16			
27	M-027	Bearing Nut	4			
28	M-028	GFA Motor	1			
29	M-029	Control Panel	1			
30	M-030	16' Motor Cable Set	1			
31	M-031	16' Encoder Cable set	1			
32	M-032	Motor Mount/Headplate Bolts	4			
33	M-033	Motor Mount/Headplate Nuts	4			
34	M-034	Motor Mount/Headplate Washers	8			
35	M-035	Aluminum Pipe	1			
36	M-036	Vinyl Curtain	1			
37	M-037	Steel End Shafts fot Aluminum Pipe	2			
38	M-038	Keyway	1			
39	M-039	Lintel Brush	1			