

MAXPRO™

INSTALLATION MANUAL FOR MANUAL OR DIRECT DRIVE MOTOR

PerformMax Industrial Doors
5 Crozerville Road, Aston, PA 19014
+1 (484) 840-8500

WWW.PERFORMAXGLOBAL.COM
INFO@PERFORMAXGLOBAL.COM

Manufacturer

PerforMax Global
5 Crozerville Road
Aston, PA 19014
Office: +1 (484) 840-8500

Door Details

Date:
Installing Dealer:
Project:
Door Model:
Serial Number:
Clear Opening Between Guides:
Clear Opening Height:

General

This Installation and Maintenance Manual is to help you install MaxPro Rubber Door and ensure the door provides reliable and economical operation. DO NOT begin to install a MaxPro Rubber Door unless you have read all the instructions in this manual. Please contact PerforMax Global Technical Support at +1 (484) 840-8500 at any time during the install.

Symbols Used in this Document



NOTICE

Highlights important information.



CAUTION

Failure to follow instructions or avoid the described situation may result in damage to equipment.



WARNING / DANGER

Failure to follow instructions or avoid the described situation may result in damage to equipment, serious injury and/or death to person(s).

Safety and Power Isolation



An understanding of the system's functions and operation by trained and competent technicians is essential for safe installation, maintenance, troubleshooting and repair.



Incoming energy to the electric motor (door operator) should be isolated using accepted Lock-Out/Tag-Out procedures for electric isolation. Also isolate any equipment near the installation site if the equipment may be inadvertently operated into the door installation area.



Use proper lifting equipment and techniques. Properly secure all loads.

SAFETY INFORMATION

TO PREVENT INJURY TO YOURSELF OR ANYONE AROUND YOU, PLEASE READ SAFETY INFORMATION AND OCCASIONAL REVIEW THEM AS YOU ARE INSTALLING A PERFORMAX GLOBAL HIGH PERFORMANCE DOOR.

- Inspect all components and call Performax Global if problems arise.
 - Be sure to anchor guides into secure walls. Only attaching to drywall or sheet rock with result in failure and/or injury.
 - If repairs are required to your high performance overhead door, please call your service provider and/or Performax Global.
 - Be sure to ask for assistance if lifting anything heavy.
 - Follow instructions carefully and check out Performax Global's YouTube videos for instructional videos.
 - If door is equipped with a torsion tube, use caution when adjusting the tension wheel.
 - Only use hardware that is supplied by Performax Global.
-
- Test safety devices before approving proper operation.
 - If grinding or cutting, but sure to wear proper personal safety equipment.
 - Head plates are carrying a lot of weight. Do not attempt to loosen without supporting the curtain first.
 - Be sure safety devices are fully operational before the door goes into operating mode.
 - Do not let children play with the controls.
 - Be sure the guides are adjusted correctly or the door will not operate correctly.
 - Only licensed operators to move heavy machinery.

STEP 1

- Anchor rear guides to wall using included hardware
- Maintain clearance width between guides at top and bottom of doorway
- Slide Lintel Brush into Lintel Retainer
- Secure Lintel Brush and Retainer 9 inches above header as shown below

Side View of Lintel and Retainer Positioning

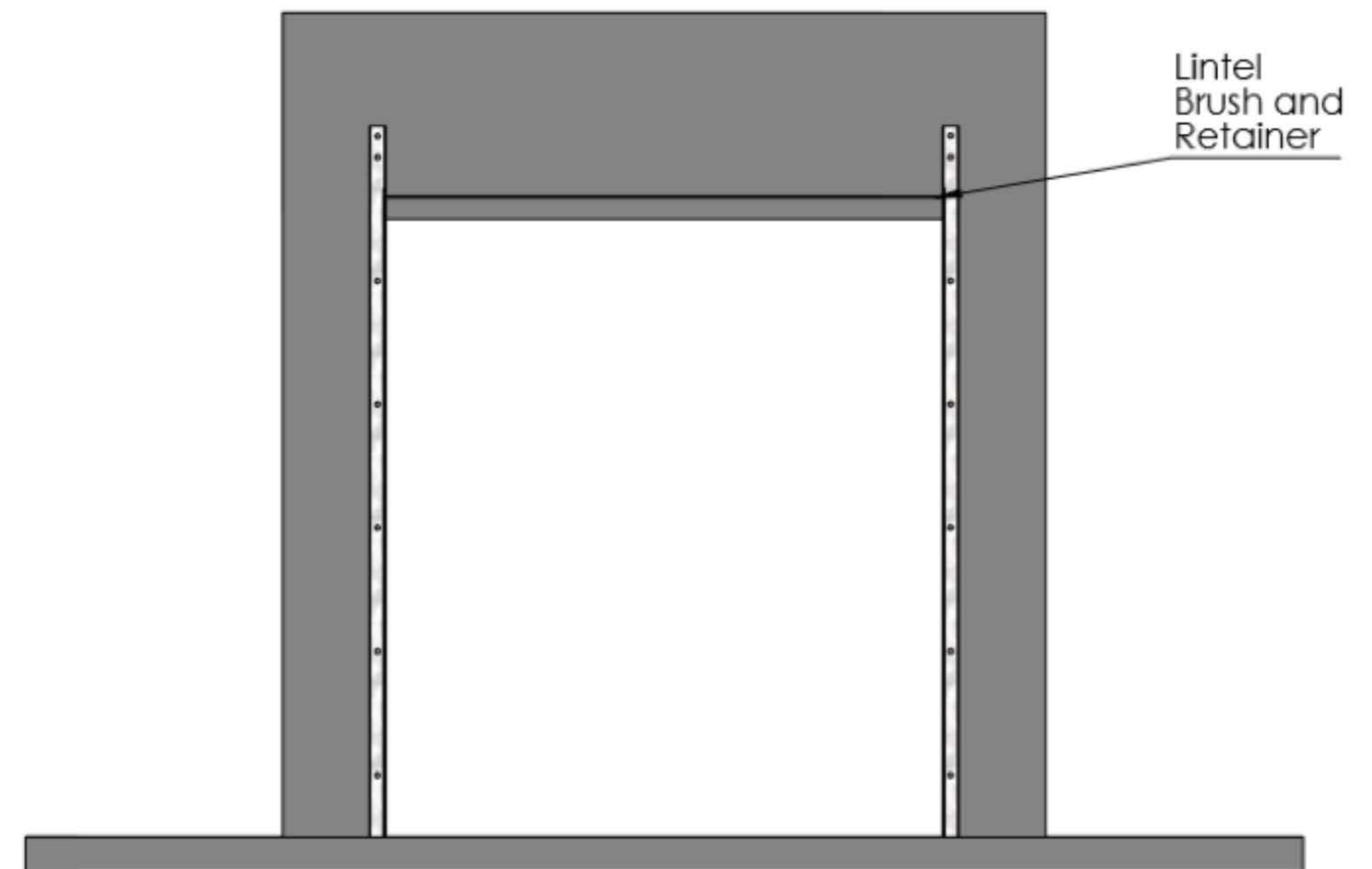
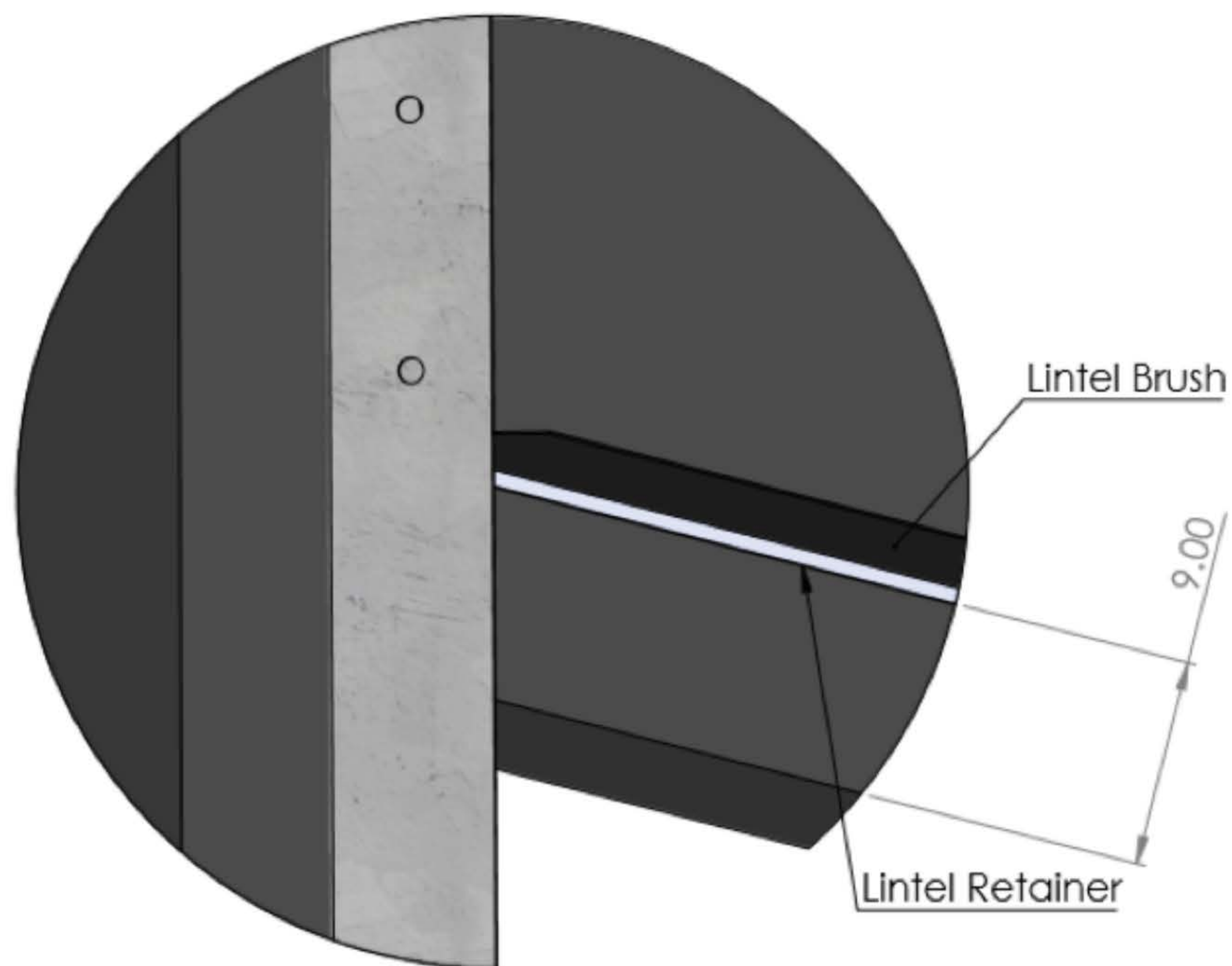

STEP 2

- Slide head plate assembly onto both shafts
- Tighten set screw slightly to lock head plate assembly to shaft

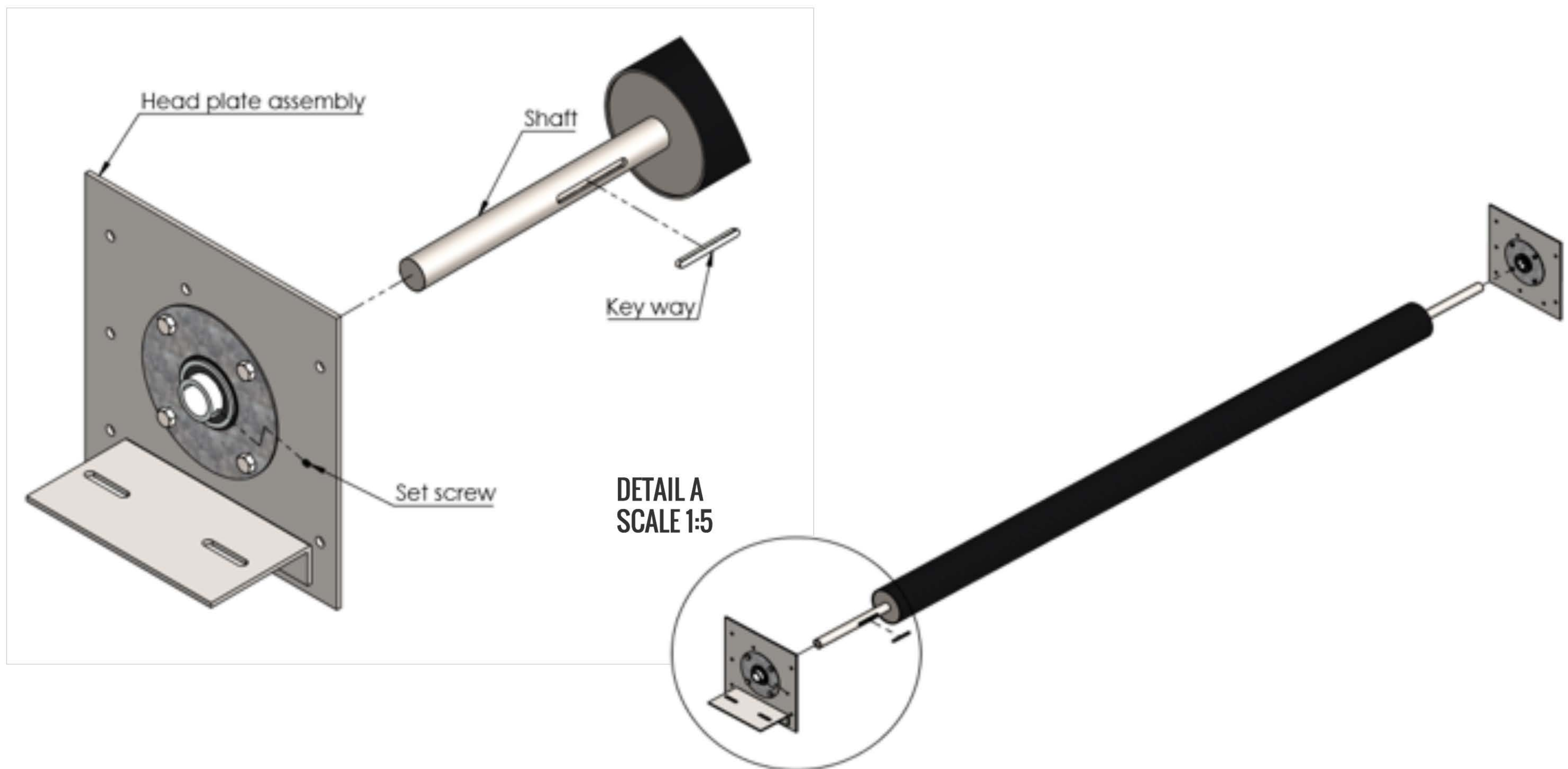

STEP 3

- Lift curtain and head plates into position
- Loosen set screws
- Bolt head plates to guides as showing below using provided hardware
- Position head plates perpendicular to the wall
- Tighten set screws

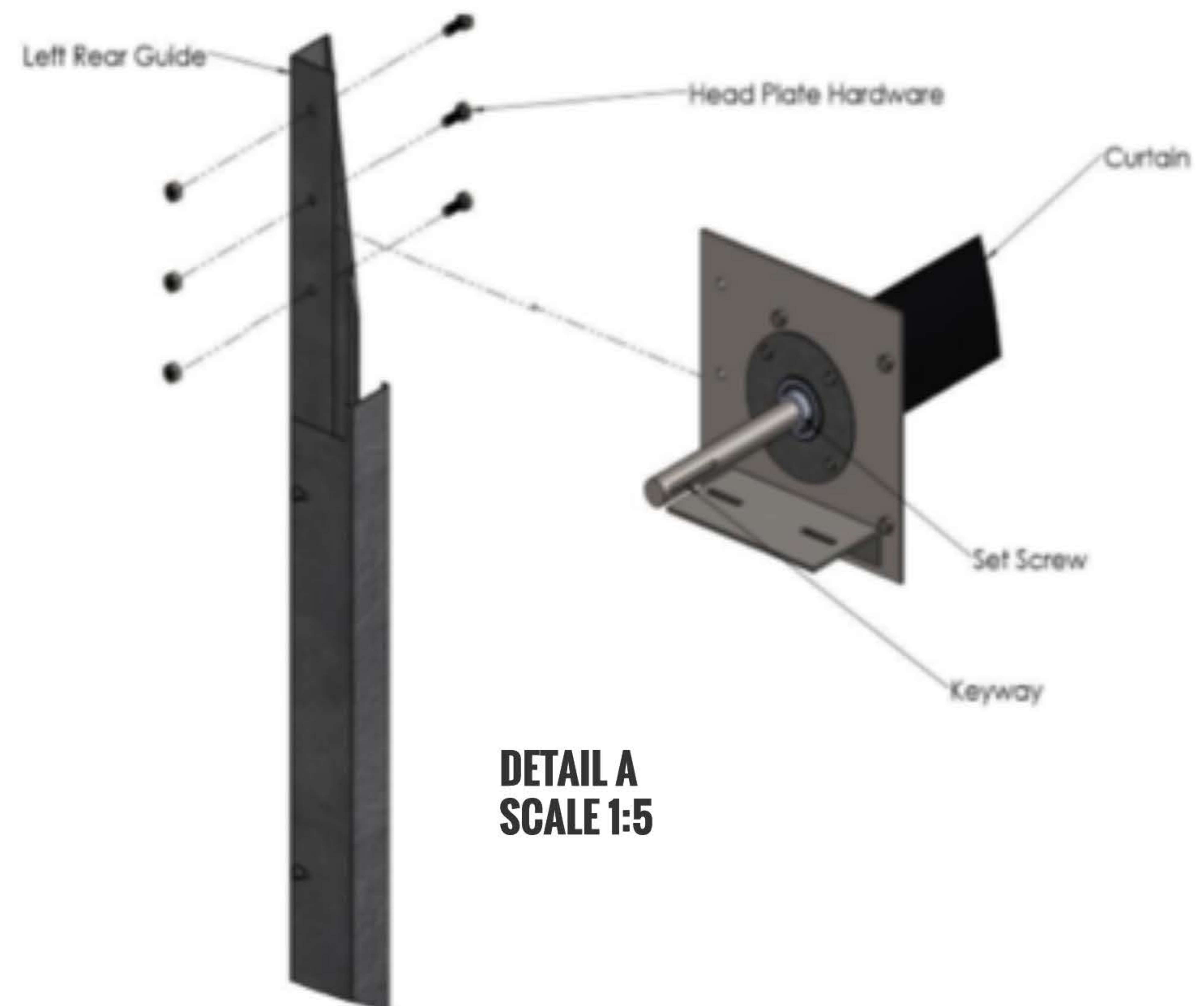
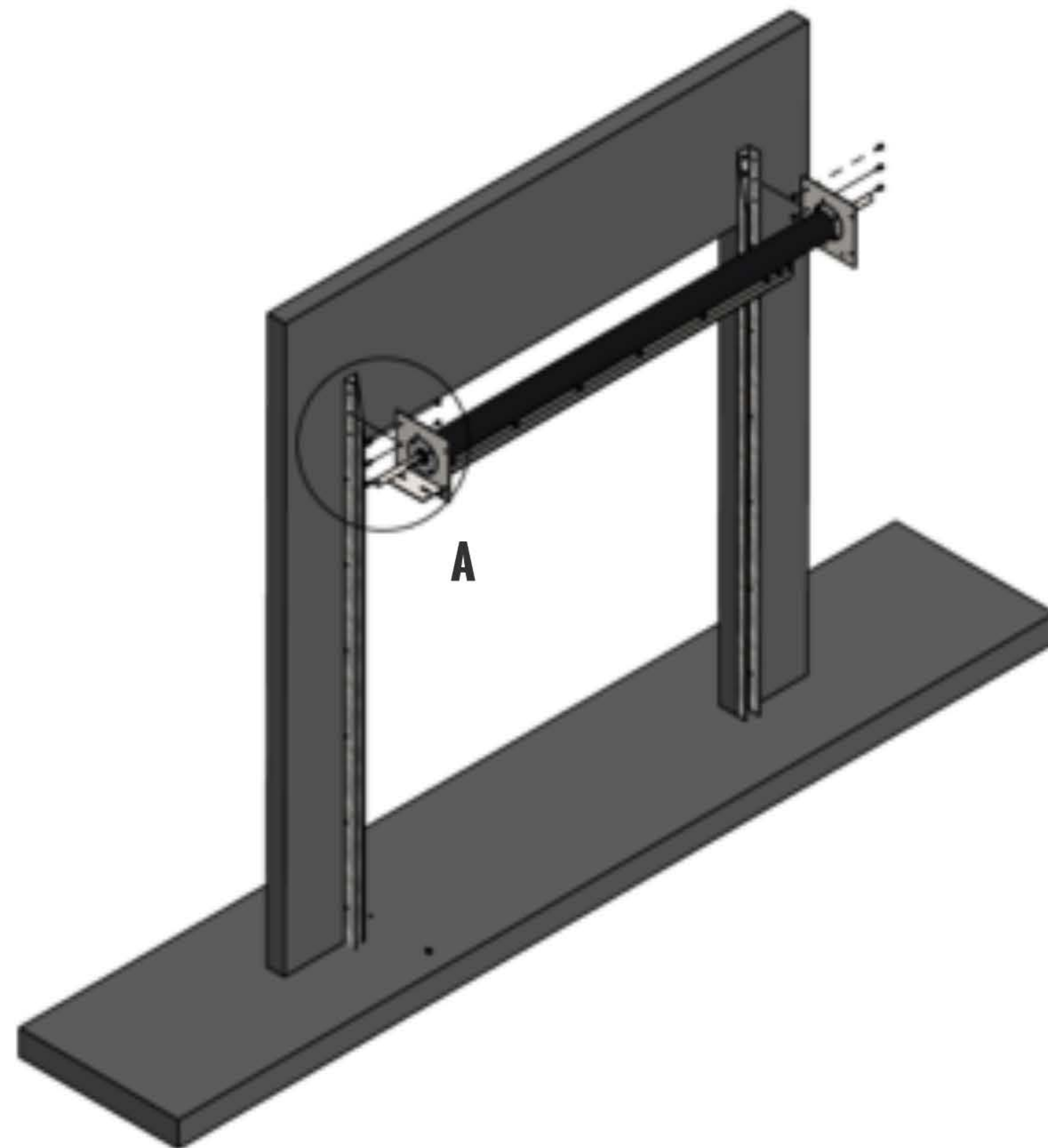

STEP 4

- Slide motor onto shaft and key
- Motor should be more than one inch from curtain
- Attach motor to motor mount using motor mount hardware

DETAIL A
SCALE 1:10

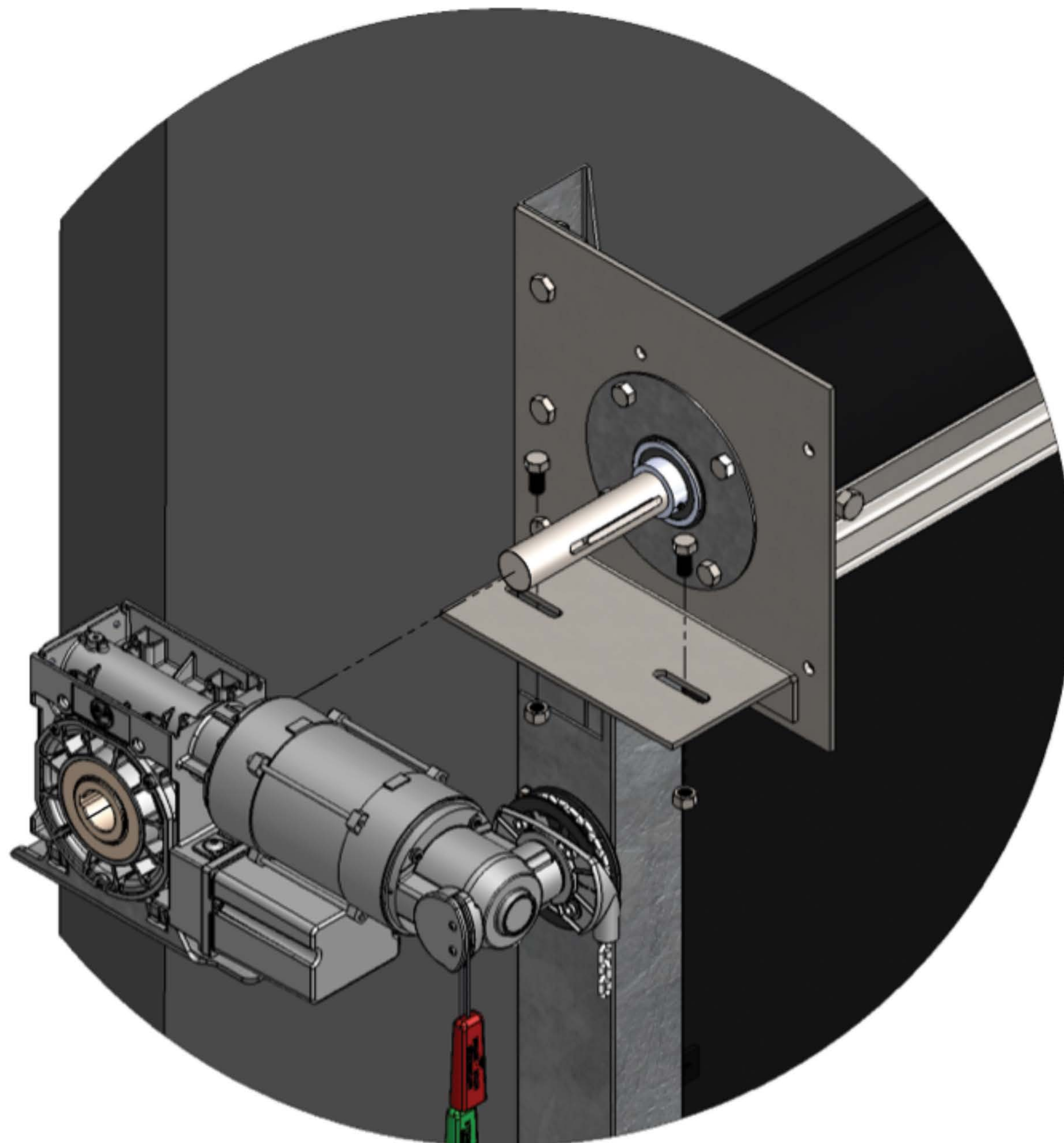

STEP 5

- Bolt guide covers to wall mounted guides using self-tapping screw, keep front guide on outside of mounted guides
- Maintain a gap of $\frac{3}{4}$ " between plastic guides when mounting

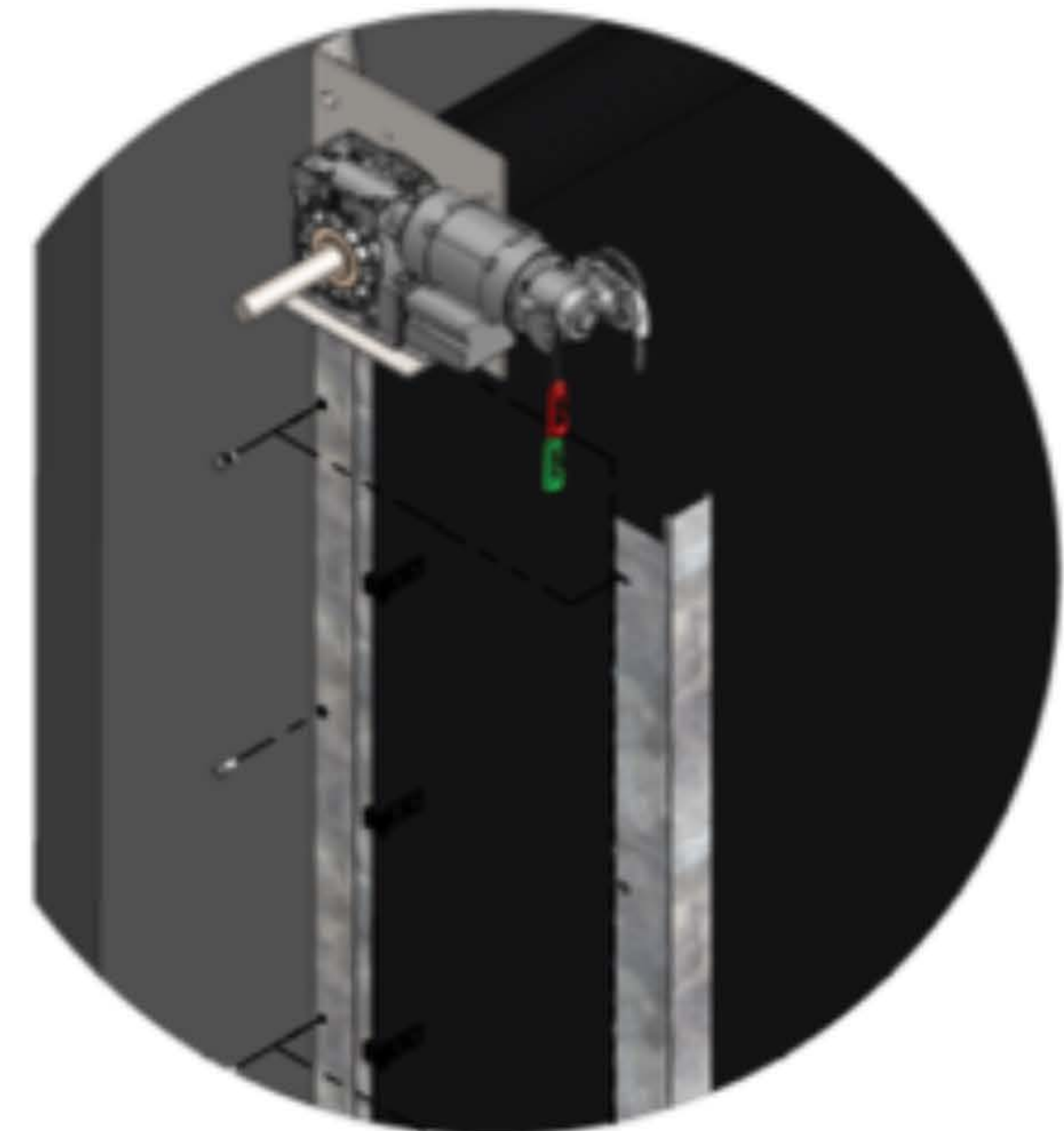
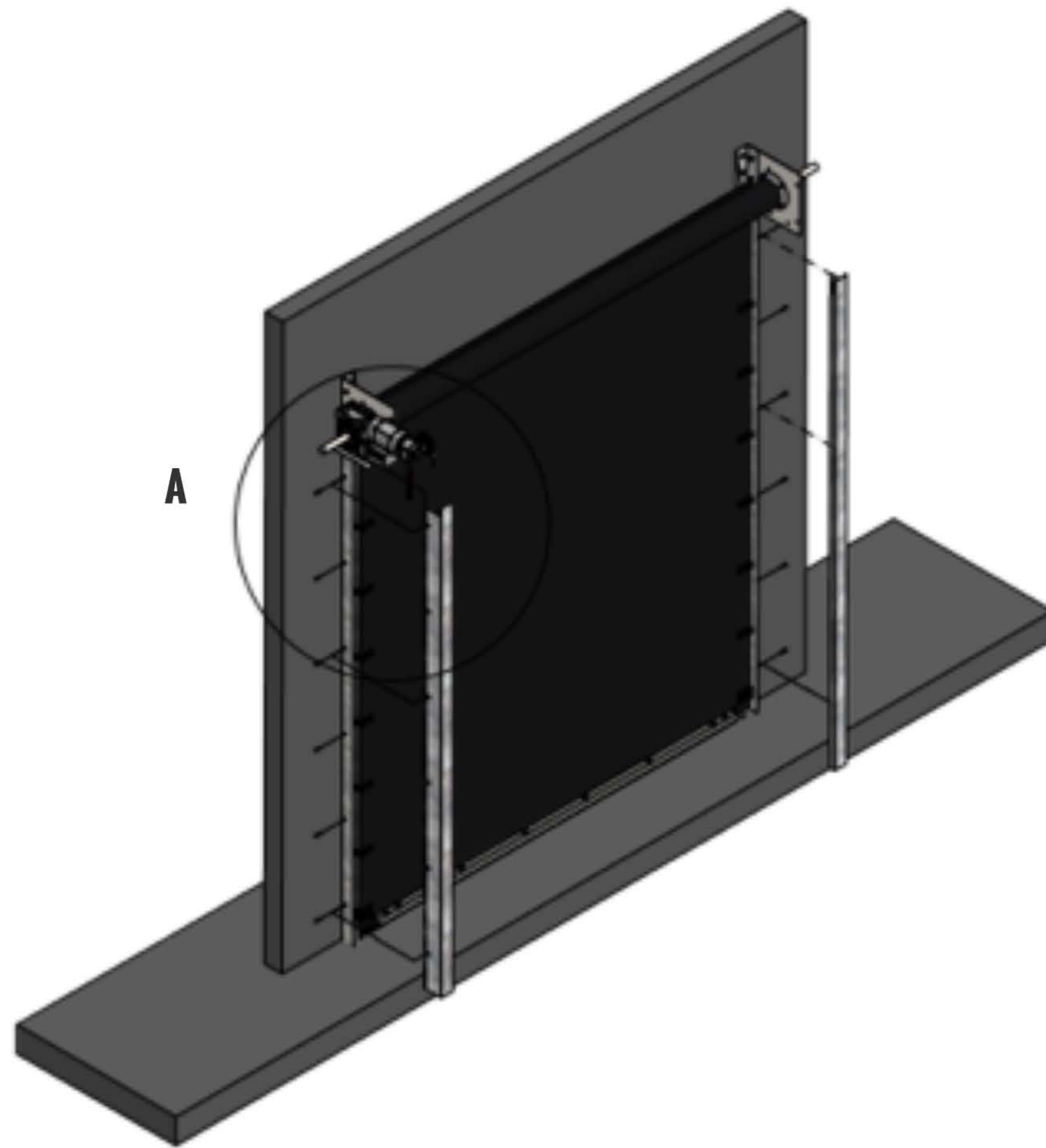

DETAIL A
SCALE 1:20

LEFT HAND GUIDE

ITEM NO.	DESCRIPTION	QTY.
1.1.1	Rear Left Guide	1
1.1.2	Front Left Guide	1
1.2.1	Self Threading Bolts	Varies

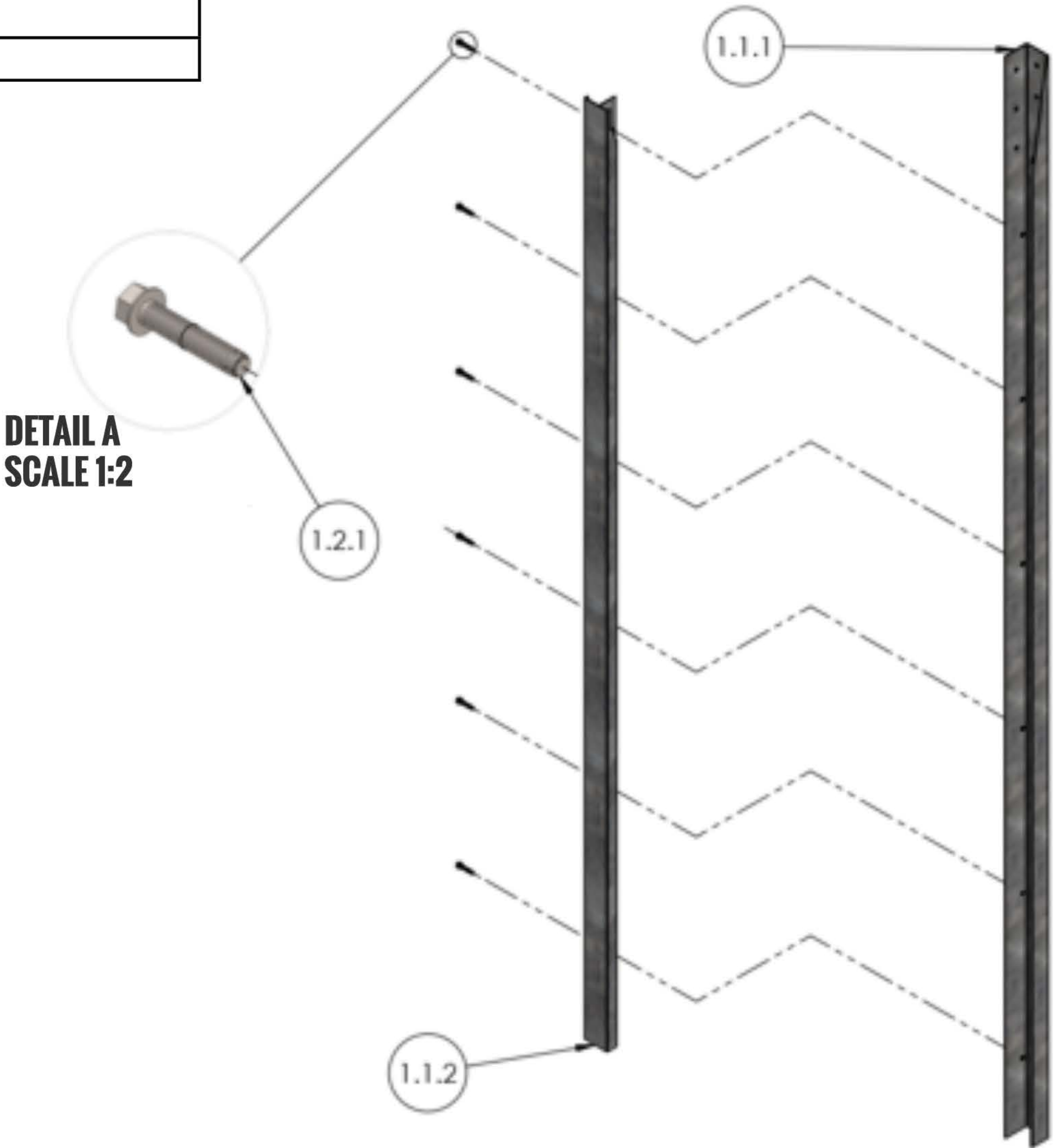

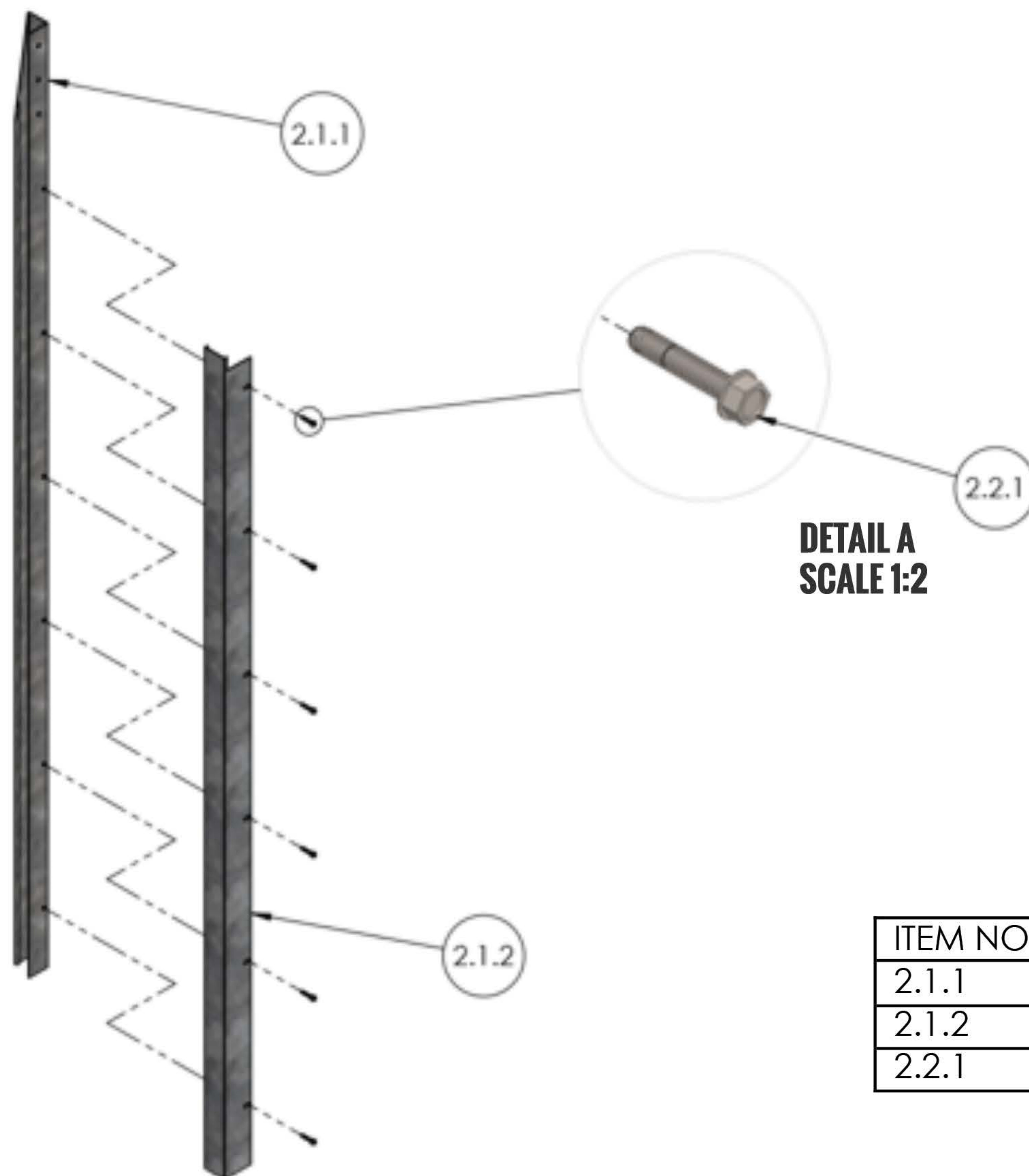

RIGHT HAND GUIDE

ITEM NO.	DESCRIPTION	QTY.
2.1.1	Rear Left Guide	1
2.1.2	Front Left Guide	1
2.2.1	Self Threading Bolts	Varies

PIPE

ITEM NO.	DESCRIPTION	QTY.
3.1.1	Pipe	1
3.2.1	Key Way	1

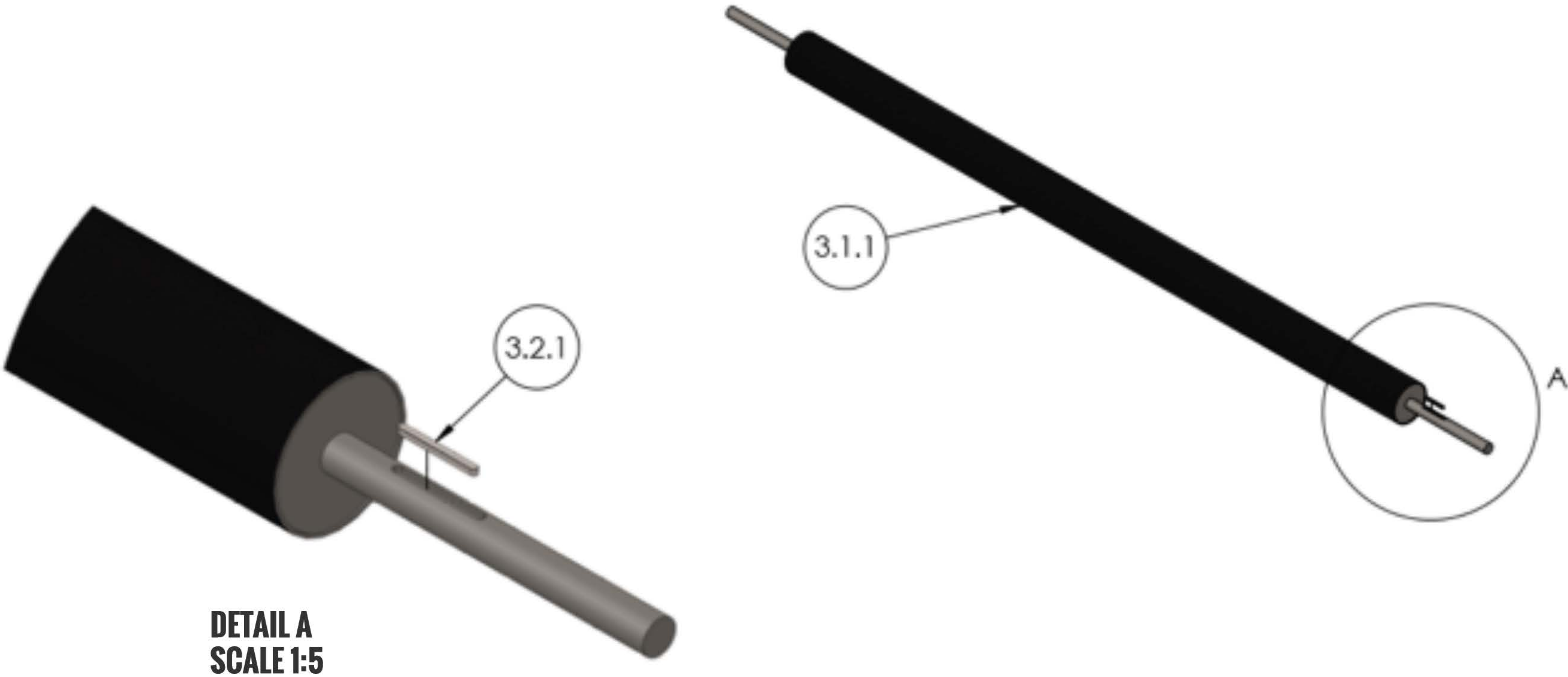

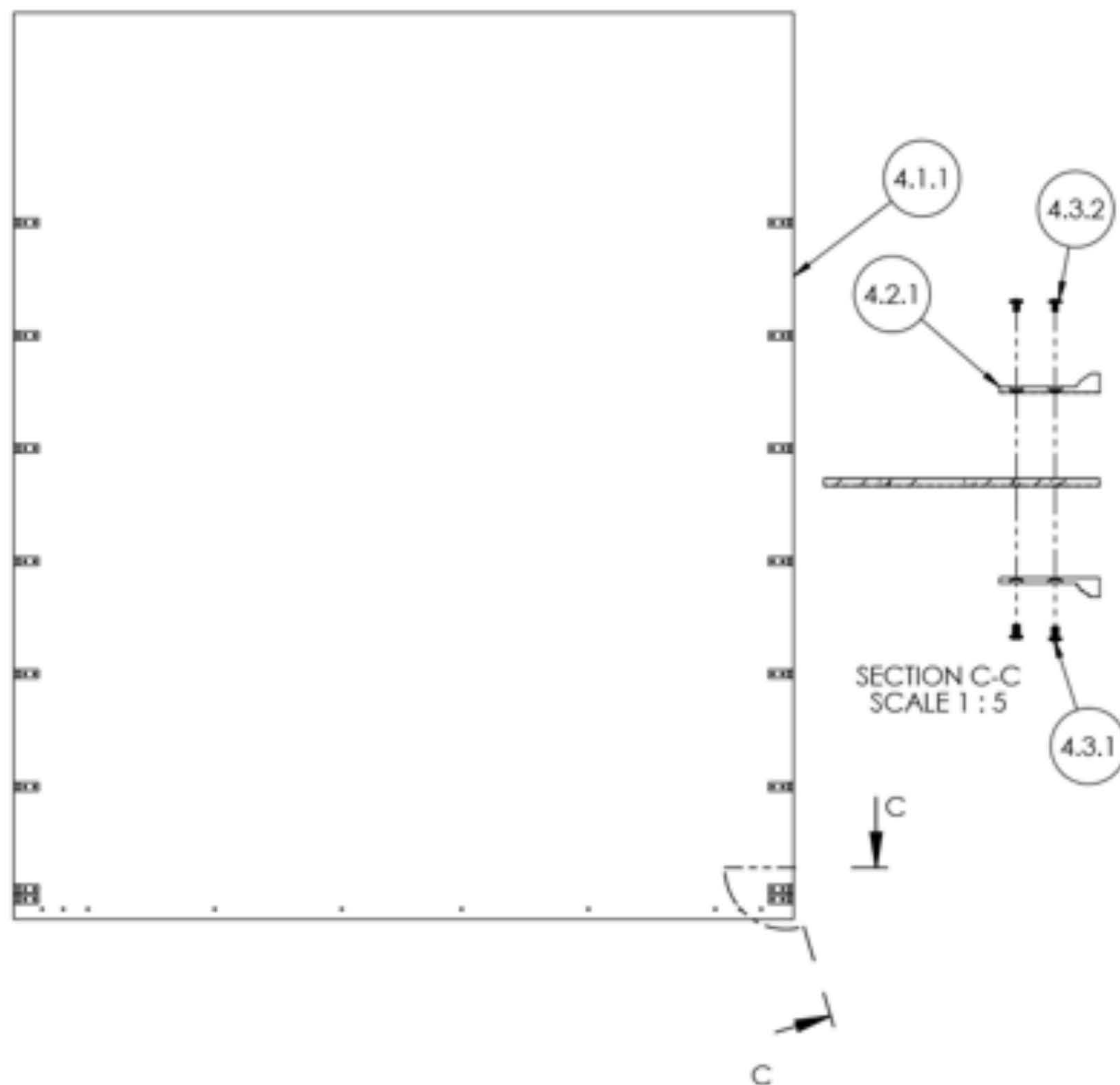

CURTAIN

ITEM NO.	DESCRIPTION	QTY.
4.1.1	Curtain, Black SBR Rubber	1
4.2.1	End Lock/Wind Tab, HDPE Plastic	Varies
4.3.1	Screws, female 10-24 x 3/8 SST	Varies
4.3.2	Screws, male 10-24 x 3/8 SST	Varies

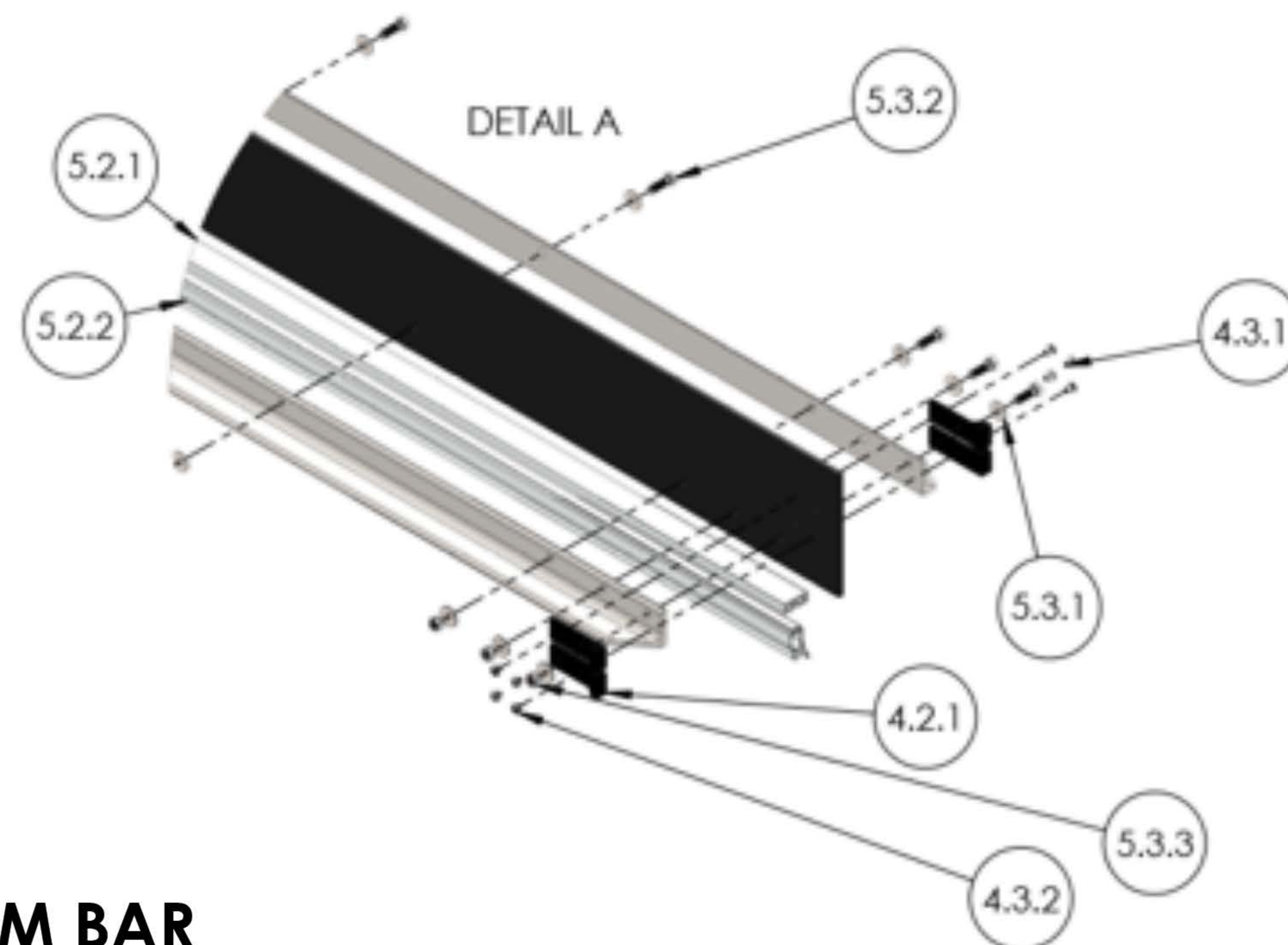
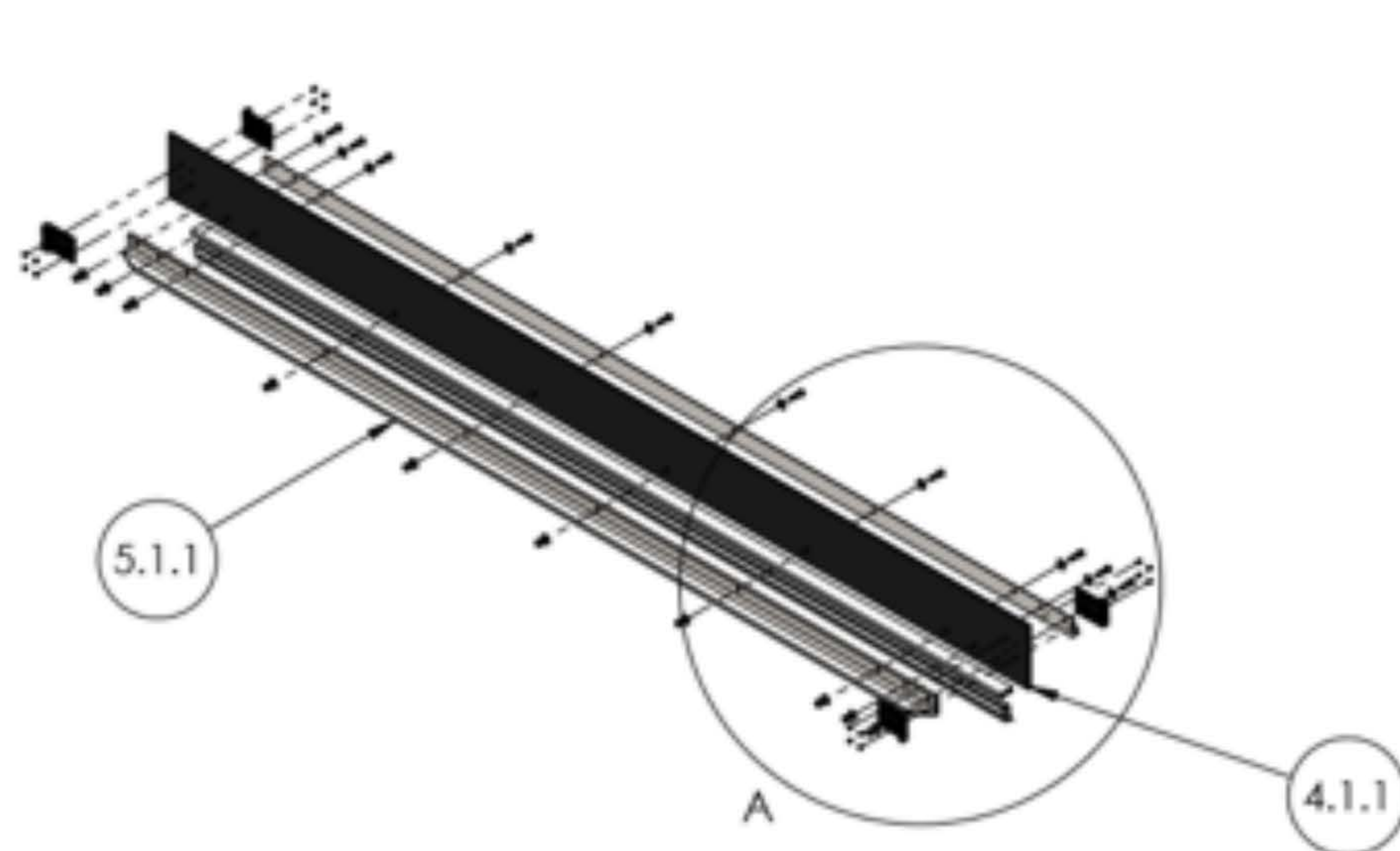

BOTTOM BAR

ITEM NO.	DESCRIPTION	QTY.
4.1.1	Curtain, Black SBR Rubber	1
4.2.1	End Lock/Wind Tab, HDPE Plastic	Varies
4.3.1	Screws, female 10-24 x 3/8 SST	Varies
4.3.2	Screws, male 10-24 x 3/8 SST	Varies
5.1.1	Bottom Bar, Front/Rear	2
5.2.2	Safety Edge	1
5.2.1	Safety Edge Bracket	1
5.3.1	Washer	Varies
5.3.2	Bolt	Varies
5.3.3	Nut	Varies

HEAD PLATE

ITEM NO.	DESCRIPTION	QTY.
1.1.1	Rear Left Guide	1
1.1.2	Front Left Guide	1
2.1.1	Rear Right Guide	1
2.1.2	Front Right Guide	1
3.1.1	Pipe	1
6.1.1	Head Plate	2
6.2.1	Motor Mount	1
6.3.1	Bearing	2
6.3.2	Bearing Flange	4
6.4.1	BOLT	Varies
6.4.2	NUT	Varies
6.4.3	GUIDE BOLT	Varies
6.4.4	GUIDE BOLT	Varies

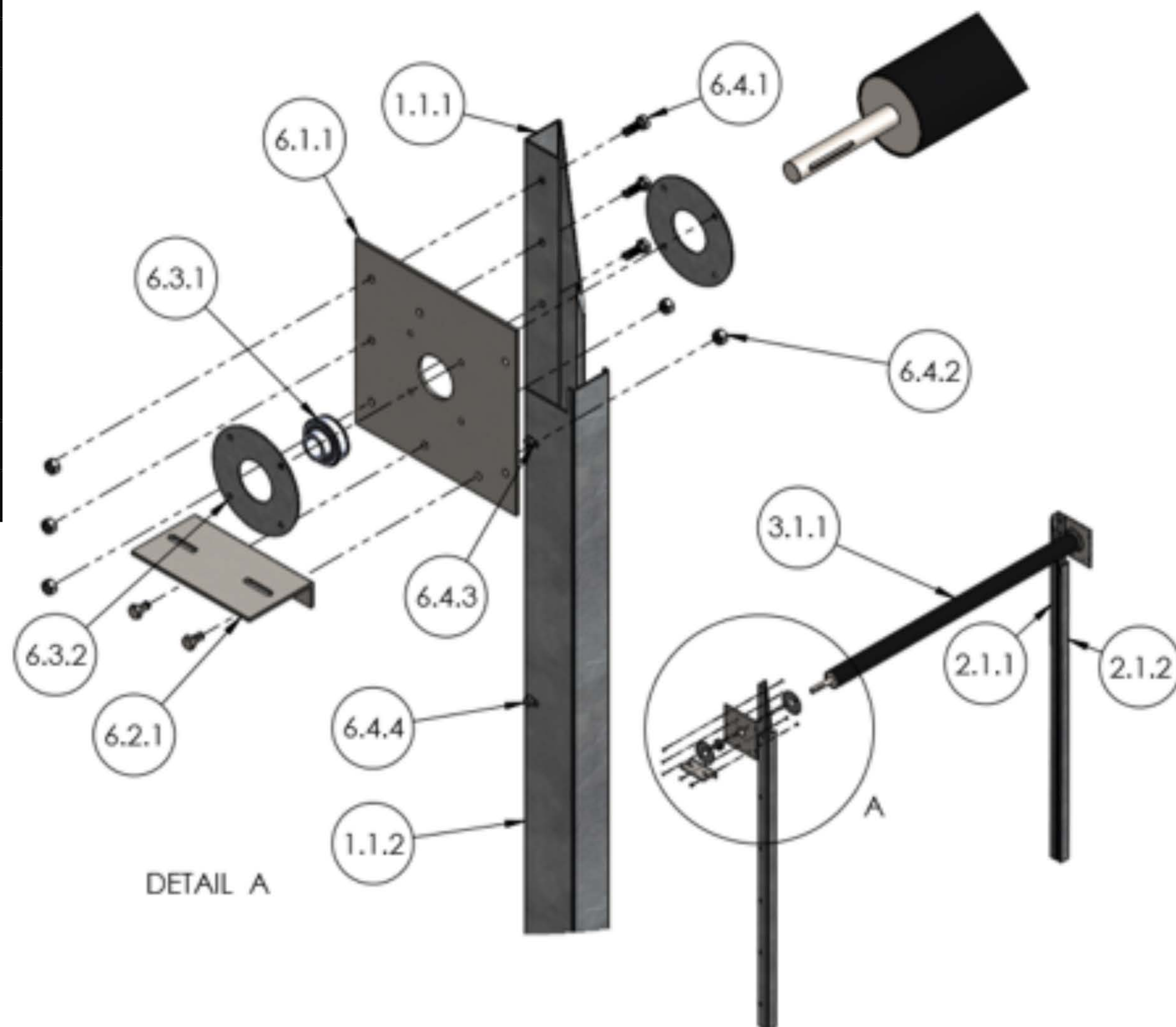

MOTOR

ITEM NO.	DESCRIPTION	QTY.
3.1.1	Pipe	1
6.1.1	Head Plate	2
6.2.1	Motor Mount	1
6.3.1	Bearing	2
6.3.2	Bearing Flange	4
7.1.1	Electric Motor, Variable Speed	1
7.1.2	Key Way	1
7.2.1	BOLT	2
7.2.2	NUT	2
7.2.3	BOLT	4
7.2.4	BOLT	2
7.2.5	NUT	2

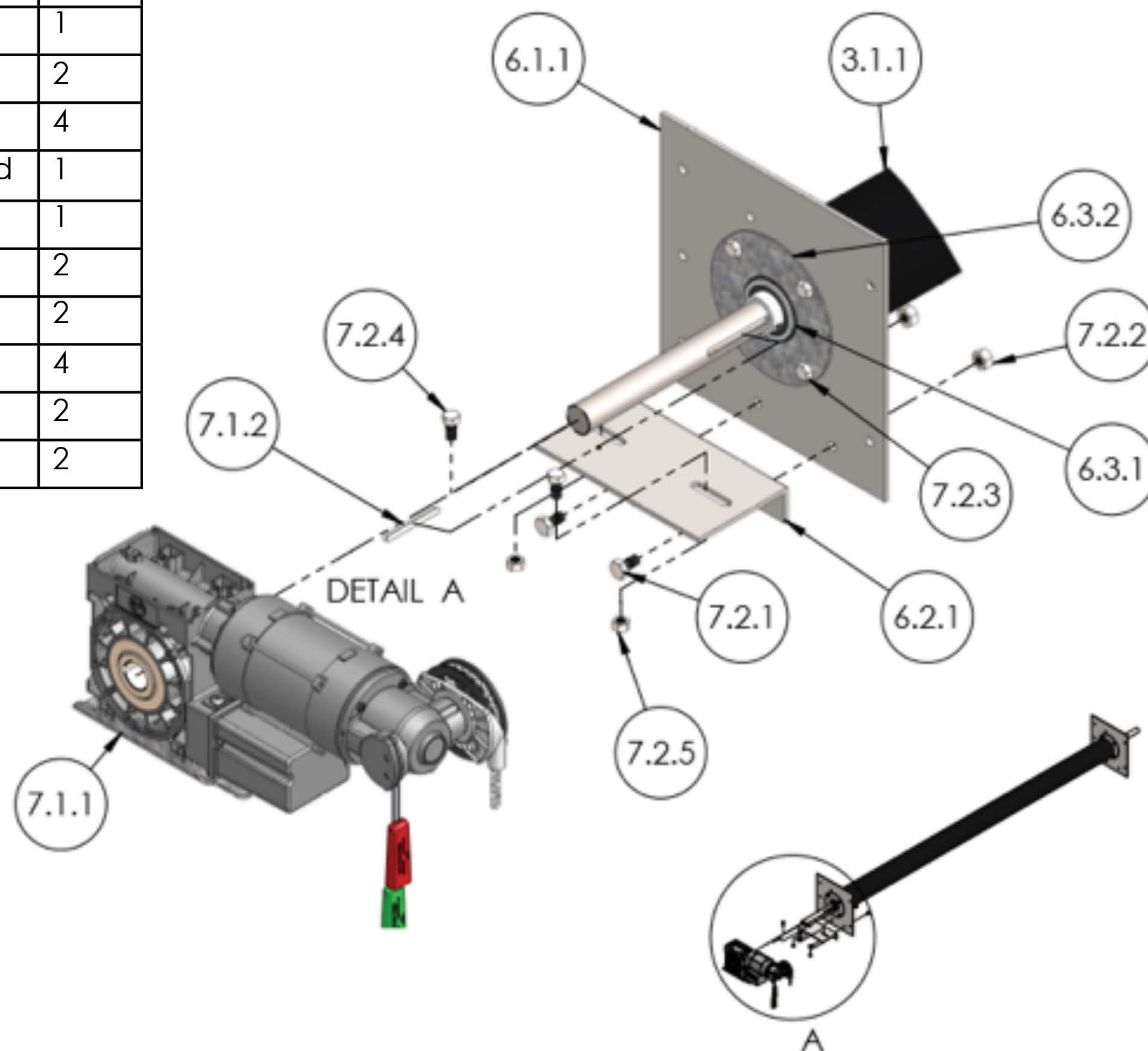

MAXPRO PARTS LIST

Item #	Part #	MaxPro Item	Item Description	Quantity		Part # Options	Options
1	P-001	Rear Right Guide	Rear Right Guide	1		P-038	Wireless safety edge
2	P-002	Front Left Guide	Front Left Guide	1		P-039	Safety edge coil cord
3	P-003	Front Right Guide	Front Right Guide	1		P-040	Safety edge junction box
4	P-004	15 inch Head Plate	Head Plate	2		P-041	Safety edge junction box bolt
5	P-005	Motor Mount	Motor Mount	1		P-042	Safety edge junction box nut
6	P-006	HHFBOLT 0.5000-20x1x1-S	Bolt	8		P-043	Safety edge junction box washer
7	P-007	HHNUT 0.5000-20-D-S	Bolt	8		P-044	Thru beam photoeye
8	P-008	FHTS 0.375-24-G-1.125-S	Nut	1		P-045	Reflective photoeye transmitter/reciver
9	P-009	FHTS 0.375-16-F-1.125-S	Nut	11		P-046	Reflective photoeye reflector
10	P-010	Bearing Flanges	Bearing Flange	4		P-047	Reflective photoeye bracket
11	P-011	HBOLT 0.3750-16x1x1-S	Bolt	4		P-048	Window
12	P-012	HNUT 0.3750-16-D-S	Nut	8		P-049	Window Rivets
13	P-013	insert bearings	Bearings	2		P-050	Hood Cover
14	P-014	HBOLT 0.3750-24x1x1-S	Bolt	4		P-051	Motor Cover
15	P-015	Bottom Bar	Bottom Bar, Front/Rear	2		P-052	Spreader bars
16	P-016	Rear Left Guide	Rear Left Guide	1		P-053	Spreader bar bolts
17	P-017	Pipe for Rolling Steel Replacement Door	Pipe	1		P-054	Spreader bar nuts
18	P-018	Door SafetyEdge Bracket	Bracket	1		P-055	Spreader bar washers
19	P-019	Door SafetyEdge	Edge	1		P-056	3 - button station
20	P-020	Door SBR Curtain	Curtain	1		P-057	Mushroom button
21	P-021	End Tabs - angled	End Lock/Wind Tab, HDPE Plastic	32		P-058	Loop detector
22	P-022	Screws, female 10-24 x 3/8 SST	Female end tab screws	32		P-059	Falcon Eye
23	P-023	Screws, male 10-24 x 3/8 SST	Male end tab screws	32		P-060	Wireless Transmitter
24	P-024	Regular FW 0.375	Bolt	20		P-061	Wireless Receiver
25	P-025	HBOLT 0.6250-18x0.625x0.625-S	Bolt	10		P-062	Flange Mount Disconnect
26	P-026	B18.2.2.4M - Hex flange nut, M10 x 1.5, with 5 WAF --S	Nut	10			
27	P-027	HBOLT 0.6250-18x1.5x1.5-S	Bolt	6			
28	P-028	HNUT 0.3750-24-D-N	Nut	6			
29	P-029	25.12 GFA Motor (specify voltage)	Motor	1			
30	P-030	HHSBOLT 0.5000-13x2x2-S	Bolt	14			
31	P-031	HBOLT 0.5000-20x1x1-S	Bolt	2			
32	P-032	HNUT 0.5000-20-D-S	Nut	2			
33	P-033	Emergency Chain Hoist	Hoist	1			
34	P-034	Lintel brush	Brush	1			
35	P-035	Curtain Pipe	Pipe	1			
36	P-036	Curtain to pipe strap	Strap	1			
37	P-037	Crash Plate	Plate	1			